

CABINET (TRAFFIC AND PARKING) COMMITTEE

5 MARCH 2014

TRAFFIC REGULATION ORDER (TRO) – EXPERIMENTAL TRO, GREAT
MINSTER STREET AND MARKET LANE, WINCHESTER

REPORT OF ASSISTANT DIRECTOR (BUILT ENVIRONMENT)

Contact Officer: Neville Crisp Tel No: 01962 848484

RECENT REFERENCES:

CAB2444(TP) - 25th February 2013

EXECUTIVE SUMMARY:

As part of the environmental improvement works in Great Minster Street, Winchester jointly funded by HCC and WCC, the City Council undertook to implement traffic management measures.

Width limit and access restrictions were introduced under an Experimental Traffic Regulation Order, which came into effect on 4 July 2013, so that their impact could be assessed. These have proved successful and it is now recommended that they be made permanent.

RECOMMENDATIONS:

- 1 That the Experimental Traffic Regulation Order for Great Minster Street and Market Lane, Winchester be made permanent.
- 2 That the Head of Legal and Democratic Services be authorised to make a permanent Order as detailed in Appendix A.

CABINET (TRAFFIC AND PARKING) COMMITTEE

5 MARCH 2014

TRAFFIC REGULATION ORDER - EXPERIMENTAL TRO, GREAT MINSTER STREET AND MARKET LANE, WINCHESTER

REPORT OF ASSISTANT DIRECTOR (BUILT ENVIRONMENT)

DETAIL:

1 Introduction

- 1.1 In accordance with CAB2444(TP), an Experimental Traffic Regulation Order was introduced for a 6' 0" width restriction (with no access exemptions) in Great Minster Street and two-way traffic was introduced in Market Lane between St Maurice's Covert and its junction with Market Street.
- 1.2 The Experimental TRO came into operation on 4 July 2013 following the completion of the construction works in Great Minster Street.
- 1.3 Only one objection has been received following the introduction of the Order. This relates to the potential impact on disabled persons accessing this part of the city centre of making Market Lane two-way and also access to the disabled bays at the rear of Debenhams. The objection was submitted within a few days of the experimental order being implemented and was based on worries about the potential impact of the changes. Due to the location of the site, the effect of the experimental order has been very closely monitored and no issues have been observed. No issues have been reported to the Council.
- 1.4 There have been no traffic management problems resulting from the changes. The two way traffic in Market Lane can be regarded as being a significant benefit when the High Street market is in place as access for deliveries etc is still possible to The Square.
- 1.5 The Experimental TRO is considered successful and it is therefore proposed to introduce the changes permanently.

OTHER CONSIDERATIONS:

2 COMMUNITY STRATEGY AND PORTFOLIO PLANS (RELEVANCE TO):

- 2.1 The proposal is in keeping with the Community Strategy in its attempt to provide a high quality environment & safe and strong communities.

3 RESOURCE IMPLICATIONS:

- 3.1 The cost of implementing the permanent traffic regulation order will be covered by the Traffic Management agreement with Hampshire County Council.

4 RISK MANAGEMENT ISSUES

- 4.1 Risks are fully considered as part of the assessment process of all Traffic Regulation Orders. The changes/issues covered by the individual TRO requests will be subject to individual assessments and are therefore not expected to result in any significant risks.

BACKGROUND DOCUMENTS:

None.

APPENDICES:

Appendix A: Statement of Reasons and Schedule.

Appendix B: Copies of Drawings No.s 810402/280/001 & 002.

Appendix C: Copy of Notice.

Appendix D: Copy of Experimental Order.

Appendix E: Copy of comments received.

PROPOSED VARIATION TO:-

THE CITY OF WINCHESTER (CENTRAL AREA)
TRAFFIC REGULATION (CONSOLIDATION) ORDER 1984

STATEMENT OF REASONS FOR REVISION:-

On traffic management and environmental grounds to:-

Revoke the one-way traffic order in Market Lane, Winchester (that length of road which extends from its junction with Market Street to its junction with Paternoster Row)

Order to be made on an experimental basis for 18 months.

EXISTING ITEM(S) TO BE DELETED

THE CITY OF WINCHESTER (CENTRAL AREA)
TRAFFIC REGULATION (CONSOLIDATION) ORDER 1984

SECOND SCHEDULE

ONEWAY TRAFFIC FLOWS (ARTICLES 3 AND 4)

First Column

Second Column

Market Lane (that length of road which extends from
Its junction with Market Street to its junction with Paternoster Row)

Easterly

PROPOSED NEW ORDER

(there is an existing 6' 6" width limit (except for access) signed but the TRO is not on file)

STATEMENT OF REASONS:-

On traffic management and environmental grounds to:-

Introduce a 6' 0" width restriction in Great Minster Street, Winchester with no exception for access.

Order to be made on an experimental basis for 18 months.

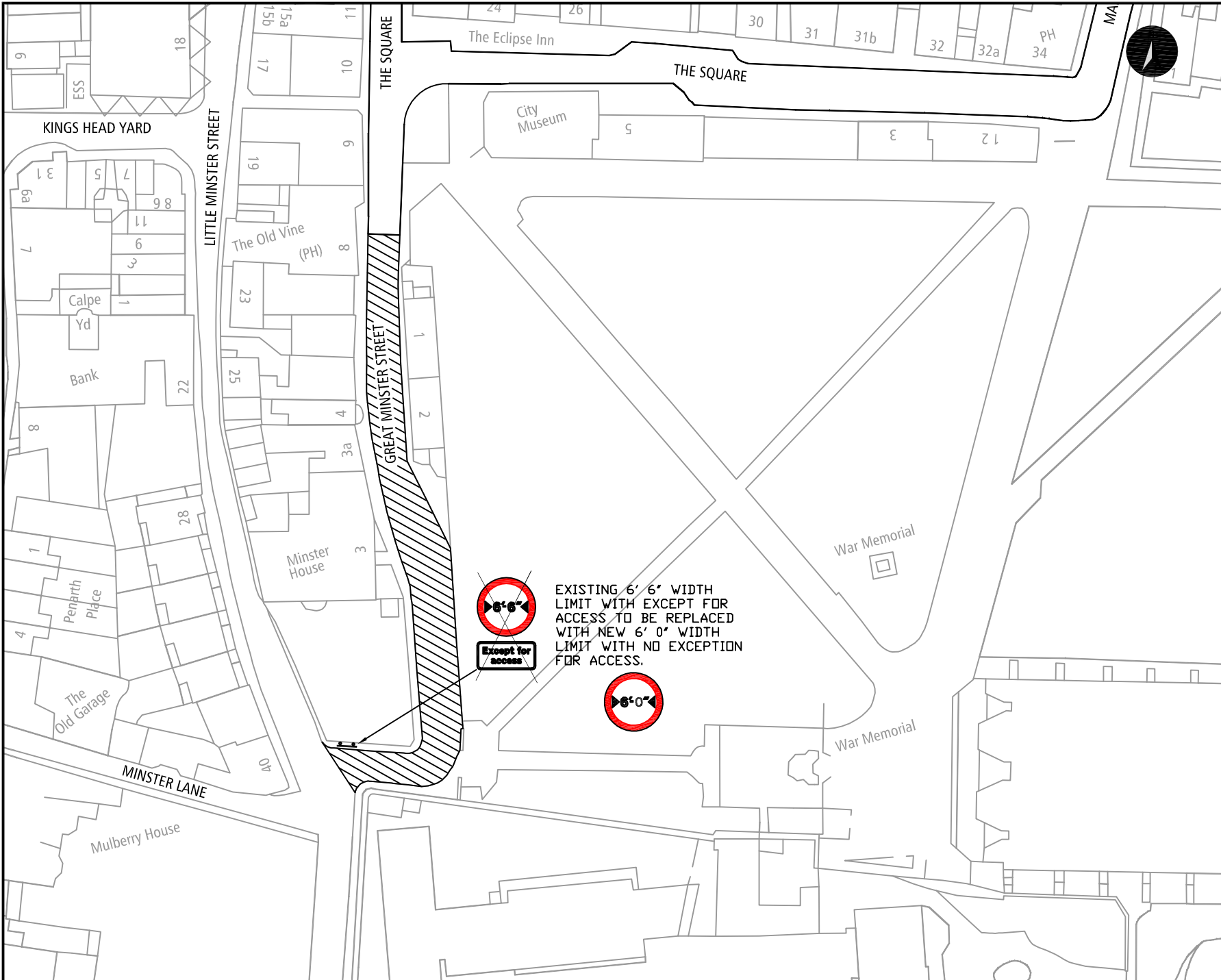

© Crown copyright and database rights
Winchester City Council license 100019531

KEY
 EXTENT OF NEW WIDTH LIMIT

Rev.	Description	Date	Drawn

Winchester
 City Council

OPERATIONS GROUP
 BUILT ENVIRONMENT
 City Offices
 Colebrook Street
 Winchester,
 SO23 9JJ

Scale: NTS
 Date: MAY 2013

Drawn: NVC
 Checked:
 Status:
 DRG. No. 810402/280/001

Project:
 EXPERIMENTAL TRAFFIC
 REGULATION ORDER

Title:
 NEW 6' 0" WIDTH
 RESTRICTION
 GREAT MINSTER STREET
 WINCHESTER

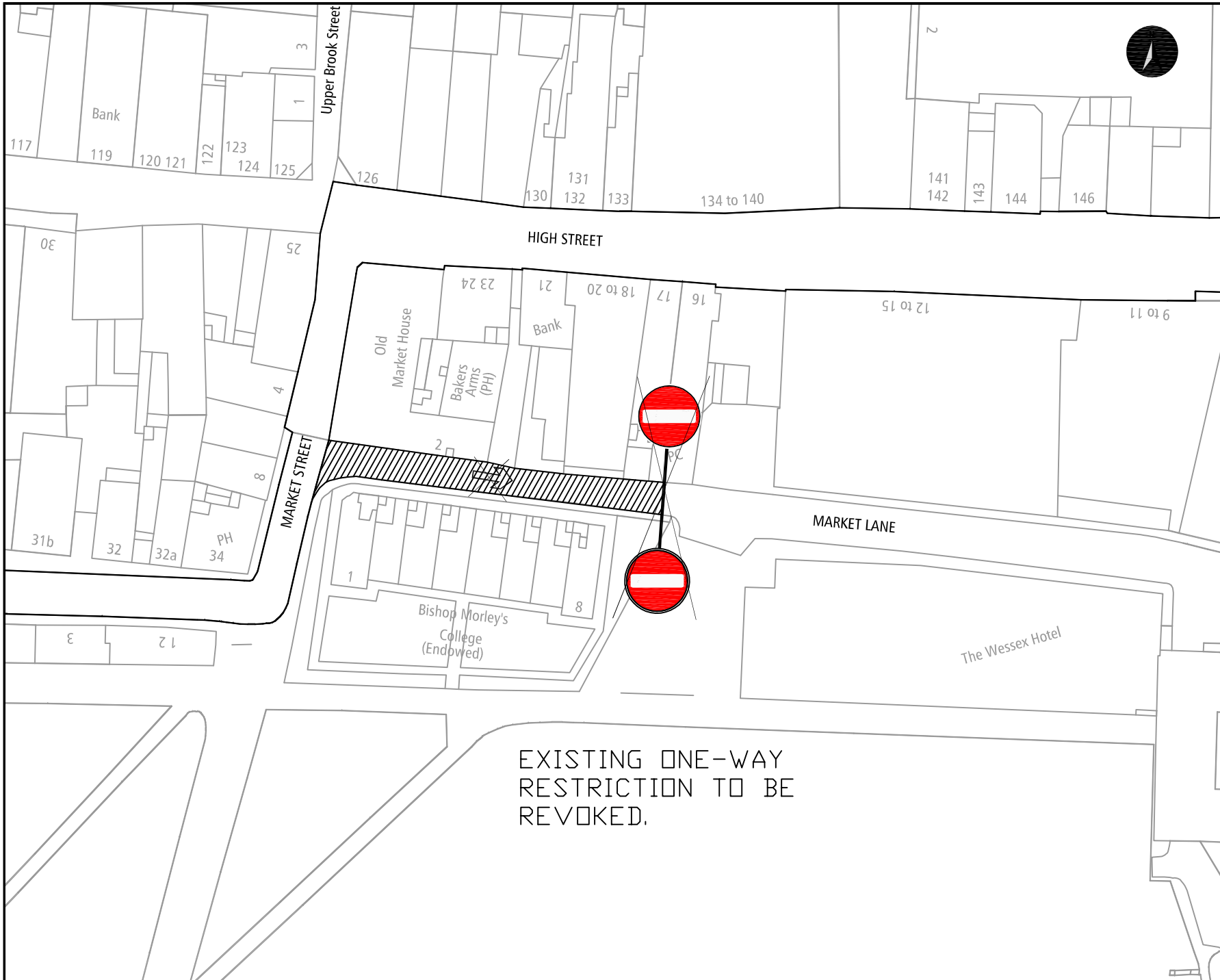

EXISTING ONE-WAY
RESTRICTION TO BE
REVOKED.

© Crown copyright and database rights
Winchester City Council license 100019531

KEY

 EXTENT OF ONE-WAY
RESTRICTION TO BE
REVOKED



Rev.	Description	Date	Drawn



Winchester
City Council

OPERATIONS GROUP
BUILT ENVIRONMENT
City Offices
Colebrook Street
Winchester,
SO23 9JJ.

© Winchester City Council

Project:
EXPERIMENTAL TRAFFIC
REGULATION ORDER

Title:
REVOKE EXISTING
ONE-WAY TRAFFIC ORDER

MARKET LANE
WINCHESTER

Scale: NTS	Date: MAY 2013
Drawn: NVC	Checked:
DRG. No. 810402/280/002	Status:

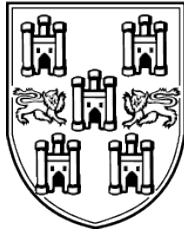

Winchester

City Council

TRAFFIC REGULATION ORDER

The Hampshire (Great Minster Street and Market Lane, Winchester) (Experimental) Traffic Regulation Order 2013

TAKE NOTICE that on 26th June 2013 Winchester City Council on behalf of Hampshire County Council made an experimental traffic regulation order as follows :-

EFFECT OF ORDER: To introduce a maximum vehicle width limit of 6 feet for the whole of Great Minster Street, Winchester and to introduce two way traffic in Market Lane, Winchester:-

IMPLEMENTATION: The Order will come into effect on 4th July 2013.

The Order is to be on an experimental basis for a maximum period of 18 months and the Council will, in due course consider whether the provisions of the Order should continue in force indefinitely.

OBJECTIONS: Within a period of six months from when the experimental Order comes into force or, if the Order is subsequently varied or modified within six months of the date of the coming into force of such variation or modification any person may object to the making of an order for the purpose of such indefinite continuation.

All objections must be in writing, stating the grounds on which they are made and sent to the undersigned or by email to tro@winchester.gov.uk

FURTHER DETAILS: A copy of this notice, the order, a map showing the location and effect of the order and a statement of reasons may be inspected during usual hours at City Offices, Colebrook Street, Winchester, Hampshire.

TITLE: The order will be known as

The Hampshire (Great Minster Street and Market Lane Winchester) (Experimental) Traffic Regulation Order 2013

Dated this 26th day of June 2013

N Crisp
Engineering and Transport
Built Environment
Winchester City Council
City Offices
Colebrook Street
Winchester
Hampshire
SO23 9LJ
of TRO'S



Scan to view details

WINCHESTER CITY COUNCIL

ROAD TRAFFIC REGULATION ACT 1984

**THE HAMPSHIRE (GRETA MINSTER STREET AND MARKET LANE, WINCHESTER)
(EXPERIMENTAL) TRAFFIC REGUALTION ORDER 2013**

Hampshire County Council in exercise of its powers under Sections 1(1) and (2), 2(1) to (3) and 3(2) of the Road Traffic Regulation Act 1984 ("the Act"), Part IV of Schedule 9 to the Act, and all other enabling powers, and after consultation with the Chief Officer of Police in accordance with Part III of Schedule 9 to the Act, hereby makes the following order:-

1. In this order the "Principal Order " means "The City of Winchester (Central Area) traffic Regulation (Consolidation) Order 1984 as amended.
2. The Principal Order is varied by measures hereby authorized to suspend the operation of those items referred to in articles 3 and 4 of the Principal Order and listed in Schedule II hereto and the provisions listed in Schedule I hereto shall be in force for the duration of this Order
3. No person shall, except upon the direction or with the permission of a police constable in uniform or parking attendant, cause or permit any vehicle other than the size specified to enter at any time on any sides of road specified in Schedule I to this Order.
4. Any other provision in any order relating to width limit in Great Minster Street shall be suspended for the duration of this Order
5. Nothing in Article 3, of this order shall render it unlawful to cause or permit any vehicle to enter any road referred to in that Article for so long as may be necessary:-
 - (a) to enable a person to board or alight from a vehicle;
 - (b) to enable the vehicle, if it cannot conveniently be used for such purposes in any other road, to be used in connection with the following operations namely:-
 - (i) the removal of any obstruction to traffic;
 - (ii) to enable the vehicle to be used for fire and rescue, ambulance or police purposes; or
 - (iii) to enable the vehicle to wait owing to the driver being prevented from proceeding by circumstances beyond their control or to such waiting being necessary in order to avoid an accident.
6. This order shall come into operation on 4th July 213 and may be cited as The Hampshire (Great Minster Street and Market Lane, Winchester) (Experimental) Traffic Regulation Order 2013" and shall remain in force until the 25th day of December 2014 or such earlier date as the Council may determine

GIVEN this 26th day of June 2013

THE COMMON SEAL of WINCHESTER)
CITY COUNCIL was hereunto affixed)
in the presence of:-)

SCHEDULE I

Great Minster Street for its entire length - no access to any vehicle exceeding 6 feet in width with no exception for access

SCHEDULE II

Item to be suspended
One Way traffic Flow

First Column

Second Column

Market Lane (that length of road which extends from
Its junction with Market Street to its junction with Paternoster Row)

Easterly

Sent: 09 July 2013 16:14

To: Traffic Order Objections

Subject: Great Minster Street & Market Lane, Winchester (Experimental) TRO 2013

Dear Mr Crisp

I refer to The Hampshire (Great Minster Street & Market Lane, Winchester) (Experimental) Traffic Regulation Order 2013, recently advertised and taken into effect on 4th July 2013.

On behalf of myself and other disabled people of Winchester I must object to the plans to turn Market Lane, Winchester, into a permanent two-way traffic system.

The stretch of road on Market Lane between the rear of Debenhams and The Old Market House is much too narrow to accommodate two-way traffic, especially when vehicles are delivering goods to the rear entrances of the High Street shops.

For mobility purposes I need to use a walking frame, however because the footpath along this stretch is so narrow and uneven it is impossible for me to use and therefore I have to walk on the road. It is dangerous enough walking on this road when I only have to watch/listen for vehicles in a one-way system, as well as negotiating around parked vehicles, but having to do this in a two-way traffic system is positively frightening and an accident waiting to happen.

There is also the question of the disabled Blue Badge parking area behind Debenhams which, if approached from the Guildhall end of Market Lane, means that the disabled driver needs to perform a 3 point turn to either enter or leave the parking area. Again this is problematic enough when having to avoid vehicles delivering goods to Debenhams and the Mercure Hotel opposite, without having to cope with two-way traffic as well.

I would therefore ask you to abandon this plan immediately please.

Yours faithfully

Pine Close
South Wonston
WINCHESTER
SO21 3EB