

LR366  
FOR DECISION  
WARD(S): Twyford and Colden Common

**LICENSING SUB – COMMITTEE**

29 September 2011

Report of the Head of Legal Services

Contact Officer: John Myall. Tel No: 01962 848443

Application: Premises Licence

Premises: 1 The Old Post Office, Main Road, Colden Common, SO21 1UL

<b>Part A.</b>	<b>Report</b>	<i>Buff</i>
1	<b>Application</b>	
2	<b>Responsible Authorities</b>	
3	<b>Interested Parties</b>	
4	<b>Observations</b>	
5	<b>Conditions</b>	
6	<b>Other Considerations</b>	

<b>Part B.</b>	<b>Appendices</b>	
<b>Appendix 1</b>	<b>Application</b>	<i>White</i>
<b>Appendix 2</b>	<b>Representations from Interested Parties</b>	<i>Cream</i>
<b>Appendix 3</b>	<b>Other Appendices</b>	<i>White</i>

**Part A.****1. Application****Applicant:** Sathiskumar Chinnusamy**Premises:** 1 The Old Post Office, Main Road, Colden Common

- 1.1 This is an application under Section 17 of the Licensing Act 2003 for a premises licence in a convenience store at shop number 1, The Old Post Office, Colden Common.
- 1.2 The application is to permit the sale of alcohol for consumption off the premises from 0900 to 2300 each day.
- 1.3 The actual trading hours for the premises are proposed to be 0700 to 2300 each day.
- 1.4 Notice of the application was displayed outside of the premises for a period of 28 days until 14 September 2011, and advertised in the Hampshire Chronicle on 18 August 2011.
- 1.5 A representation was received from the Chief Officer of Police for Hampshire relating to the crime and disorder objective. As a result of negotiation, conditions were agreed relating to a CCTV system. The representation was then withdrawn.
- 1.6 A set of conditions relating the child protection objective were agreed with Trading Standards relating the prevention of sales of alcohol to under aged persons.
- 1.7 Representations were received from four interested parties. All are concerned that public nuisance will be caused by persons using the shop, and some fear the possibility of crime and disorder caused by young persons obtaining alcohol to consume in the recreation ground which is opposite the shop on the other side of Main Road.
- 1.8 There were also some references to nuisance caused by parking, however this is a traffic matter and does not fall within the licensing objectives.
- 1.9 The Operating Schedule, copied at Appendix 1, proposes the Relevant Licensable Activities and the steps to promote the licensing objectives.

**Designated Premises Supervisor****Mrs Jamil Chelvi Vijayan**

## **Relevant Representations**

### **2. Responsible Authorities**

All of the Responsible Authorities have been served with a copy of the application. The representations received are as follows:

#### **Head of Environment**

No representations received.

#### **Hampshire Constabulary**

A representation was received but later withdrawn after agreement to CCTV conditions.

#### **Hampshire Fire and Rescue Service**

No representations received.

#### **Child Protection Team**

No representations received.

#### **Head of Building Control**

No representations received.

#### **Head of Safety Standards**

No representations received.

**3. Interested Parties**

1. Ms S Mitchell
2. Miss H Wright
3. Mr A Waterman and Ms B Hatton
4. Mr M Blackstaff

#### **4. Observations**

The Sub-Committee is obliged to determine this application with a view to promoting the Licensing Objectives:

- The prevention of crime and disorder
- Public safety
- The prevention of public nuisance
- The protection of children from harm

In making its decision, the Sub-Committee is also obliged to have regard to the national guidance and the Council's licensing policy.

The Sub-Committee must have regard to all of the representations.

The Sub-Committee must take such of the following steps it considers necessary to promote the licensing objectives:

1. Grant the licence subject to conditions in accordance with the operating schedule (modified to such extent as the authority considers necessary for the promotion of the licensing objectives) and the mandatory conditions;
2. exclude from the scope of the licence any of the licensable activities to which the application relates;
3. refuse to specify a person in the licence as the premises supervisor;
4. reject the application.

#### **Terminal hours**

The Sub-Committee should take account of the national guidance and the Council's licensing policy with regard to terminal hours and take such steps as it considers necessary to promote the licensing objectives.

(Licensing Policy Part 4, A8)

#### **Licensing Objectives.**

##### Crime and Disorder

The Sub-Committee should consider any necessary conditions to prevent crime and public disorder relating to the premises having regard to the observations of the interested parties, the operating schedule, the Council's licensing policy and the national guidance.

.

(Licensing Policy 1.6, 2.11, 2.17)

### Public Safety

The Sub-Committee should consider any necessary conditions relating to public safety having regard to the operating schedule, the Council's licensing policy and the national guidance.

(Licensing Policy Part 4, B3, B4)

### Public Nuisance

The Sub-Committee should consider any necessary conditions to prevent public nuisance caused by noise and light pollution from the premises having regard to the observations of the observations of the interested parties, the operating schedule, the Council's licensing policy and the national guidance.

(Licensing Policy Part 4, Section C)

### Protection of Children

The Sub-Committee should consider any necessary conditions for the Protection of Children having regard to the observations of the interested parties, the operating schedule, the Council's licensing policy and the national guidance.

(Licensing Policy Part 4, D6, D7)

### **Human Rights**

It is considered that Articles 6 (right to a fair trial) 8 (right to respect for private and family life) and Article 1 of the First Protocol (right to peaceable enjoyment of possessions) may be relevant. As there is a right of appeal to the Magistrates' Court, it is considered that there would be no infringement of Article 6. Article 8 is relevant, insofar as the nearby residents could claim that this right would be infringed by disturbance from customers. This should be balanced against the applicants' right to use of their premises under Article 1 of the First Protocol. Interference with these rights is permitted, where this interference is lawful, necessary in a democratic society, and proportionate. Likewise, the residents may argue that their rights under Article 1 of the First Protocol would be infringed. If conditions are imposed, there should be no interference with any convention rights. To the extent that any interference may occur, it would be justifiable in a democratic society, and proportionate.

## 5. **Conditions**

### Mandatory Conditions

The following conditions are attached to a premises licence in any case.

1. No supply of alcohol may be made under the Premises Licence (a) at a —time when there is no Designated Premises Supervisor in respect of the —Premises Licence, or (b) at a time when the Designated Premises —Supervisor does not hold a Personal Licence or his Personal Licence is —suspended.
2. Every supply of alcohol under the Premises Licence must be made or authorised by a person who holds a Personal Licence.
3. Where individuals are required on premises to carry out security activities, they must be licensed by the Security Industry Authority.
4. The responsible person shall take all reasonable steps to ensure that staff on relevant premises do not carry out, arrange or participate in any irresponsible promotions in relation to the premises.
5. The premises licence holder or club premises certificate holder shall ensure that an age verification policy applies to the premises in relation to the sale or supply of alcohol.
6. The policy must require individuals who appear to the responsible person to be under 18 years of age (or such older age as may be specified in the policy) to produce on request, before being served alcohol, identification bearing their photograph, date of birth and a holographic mark.

### **Possible Conditions**

If the application is granted, the Sub-Committee may wish to consider the following conditions to reflect the Operating Schedule:

#### Operating Hours

The hours the premises may be used for the sale of alcohol shall be:

Monday to Sunday            0900 to 2300 each day

The hours the premises may open for other than Licensable Activities shall be:

Monday to Sunday            0700 to 2300 each day

### **All Licensing Objectives**

[Dealt with in relevant sections below].

#### **Crime and Disorder**

1. A CCTV System must be installed and maintained to a standard agreed with Police.
  - (a) The system must be capable of producing evidential standard quality images with a minimum of six frames per second operating in normal conditions within the public areas.
  - (b) All public areas must be covered by CCTV. This must include the front door and counter and must be capable of providing good quality head and shoulder images.
  - (c) All images must be retained for 30 days and made available to an authorised officer on request.
  - (d) There must always be a member of staff capable of operating the CCTV system whilst the premises are open for licensable activity.
  - (e) Any images recovered must be in a format that can be readily taken away and viewed on any computer operating on any windows based program acceptable to the Police, or DVD player. This will be without the requirement for addition software to be installed.
  - (f) The CCTV system must be operating at all times whilst the premises are open for licensable activity.
  - (g) Records must be made and kept for inspection to show that the system is functioning correctly and that data is being securely retained.

#### **Public Safety**

None

#### **Public Nuisance**

1. Staff shall be given appropriate instructions and training to encourage customers to leave the premises quietly and not to loiter in the vicinity of the premises so as to minimize disturbance to local residents.

#### **Protection of Children**



1. The premises licence holder shall adopt and implement the Challenge 21 scheme. (see mandatory condition 5)
2. 'Challenge 21' posters shall be displayed in prominent positions at the premises.
3. A written log shall be kept of all refusals including refusals to serve alcohol. The holder of the premises licence shall ensure that the refusals log is properly maintained and this shall involve, but is not limited to, nominating in writing a responsible person to check and sign it on a weekly basis.
4. The premises licence holder shall ensure that every individual who appears to be under 21 years of age seeking to purchase or be supplied with alcohol at or from the premises shall produce means of identification acceptable to the licensing authority proving that individual to be 18 years of age or older, Passport, photo driving licence and PASS accredited photo ID only. If the person seeking alcohol is unable to produce acceptable means of identification, no sale or supply of alcohol will be made to or for that person. (see mandatory condition 6)
5. All staff shall be trained to challenge every individual who appears to be under 21 years of age and to refuse service where individuals cannot produce acceptable means of identification. Such training shall be provided not less than every three months, and written records shall be kept of all training and refresher training.

## **6. Other Considerations**

### **Corporate Strategy (Relevance To:)**

This report covers issues which addresses the key objectives of safer communities and economic prosperity.

### **Resource Implications**

A licence fee of £100 has been received. It is anticipated that an appropriate level of officer attendance will be provided within the existing budget.

### **Appendices**

1. Application by Satishkumar Chinnusamy
2. Representations by Interested Parties
3. Map of premises location.



**Winchester**  
City Council

City Offices  
Colebrook Street  
Winchester  
SO23 9LJ

**Application for a premises licence to be granted  
under the Licensing Act 2003**

**PLEASE READ THE FOLLOWING INSTRUCTIONS FIRST**

Before completing this form please read the guidance notes at the end of the form.  
If you are completing this form by hand please write legibly in block capitals. In all cases ensure that your answers are inside the boxes and written in black ink. Use additional sheets if necessary.  
You may wish to keep a copy of the completed form for your records.

I/We SATHISHKUMAR CHINNUSAMY  
(Insert name(s) of applicant)

apply for a premises licence under section 17 of the Licensing Act 2003 for the premises described in Part 1 below (the premises) and I/we are making this application to you as the relevant licensing authority in accordance with section 12 of the Licensing Act 2003

**Part 1 – Premises Details**

Postal address of premises or, if none, ordnance survey map reference or description			
SHOP 1, THE OLD POST OFFICE COLDEN COMMON SO21 1RP			
Post town	COLDEN COMMON	Post code	SO21 1RP
Telephone number at premises (if any)			
Non-domestic rateable value of premises	£3900		

£100  
PJM 224

**Part 2 - Applicant Details**

Please state whether you are applying for a premises licence as  
Please tick yes

- a) an individual or individuals \*  please complete section (A)
- b) a person other than an individual \*
- i. as a limited company  please complete section (B)
- ii. as a partnership  please complete section (B)
- iii. as an unincorporated association or  please complete section (B)
- iv. other (for example a statutory corporation)  please complete section (B)
- c) a recognised club  please complete section (B)
- d) a charity  please complete section (B)
- e) the proprietor of an educational establishment  please complete section (B)
- f) a health service body  please complete section (B)
- g) a person who is registered under Part 2 of the Care Standards Act 2000 (c14) in respect of an independent hospital  please complete section (B)
- h) the chief officer of police of a police force in England and Wales  please complete section (B)

\* If you are applying as a person described in (a) or (b) please confirm:

Please tick yes

- I am carrying on or proposing to carry on a business which involves the use of the premises for licensable activities; or
- I am making the application pursuant to a
  - statutory function or
  - a function discharged by virtue of Her Majesty's prerogative

## (A) INDIVIDUAL APPLICANTS (fill in as applicable)

Mr <input checked="" type="checkbox"/>	Mrs <input type="checkbox"/>	Miss <input type="checkbox"/>	Ms <input type="checkbox"/>	Other Title (for example, Rev)	
Surname CHINNUSAMY			First names SATHISH KUMAR		
I am 18 years old or over				<input checked="" type="checkbox"/> Please tick yes	
Current postal address if different from premises address		37A KIDDERMINSTER ROAD CROYDON CR0 2UF			
Post Town Croydon		Postcode CR0 2UF			
Daytime contact telephone number					
E-mail address (optional)					

## SECOND INDIVIDUAL APPLICANT (if applicable)

Mr <input type="checkbox"/>	Mrs <input type="checkbox"/>	Miss <input type="checkbox"/>	Ms <input type="checkbox"/>	Other Title (for example, Rev)	
Surname			First names		
I am 18 years old or over				<input type="checkbox"/> Please tick yes	
Current postal address if different from premises address					
Post Town		Postcode			
Daytime contact telephone number					
E-mail address (optional)					

**(B) OTHER APPLICANTS**

Please provide name and registered address of applicant in full. Where appropriate please give any registered number. In the case of a partnership or other joint venture (other than a body corporate), please give the name and address of each party concerned.

Name
Address
Registered number (where applicable)
Description of applicant (for example, partnership, company, unincorporated association etc.)
Telephone number (if any)
E-mail address (optional)

**Part 3 Operating Schedule**

When do you want the premises licence to start?

ASAP

Day	Month	Year
<input type="text"/>	<input type="text"/>	<input type="text"/>

If you wish the licence to be valid only for a limited period, when do you want it to end?

Day	Month	Year
<input type="text"/>	<input type="text"/>	<input type="text"/>

Please give a general description of the premises (please read guidance note1)

SELLING GROCERIES, BREAD, MILK, NEWSPAPER  
REPORTS & ALCOHOL.

If 5,000 or more people are expected to attend the premises at any one time, please state the number expected to attend.

What licensable activities do you intend to carry on from the premises?

(Please see sections 1 and 14 of the Licensing Act 2003 and Schedules 1 and 2 to the Licensing Act 2003)

**Provision of regulated entertainment**

**Please tick yes**

- a) plays (if ticking yes, fill in box A)
- b) films (if ticking yes, fill in box B)
- c) indoor sporting events (if ticking yes, fill in box C)
- d) boxing or wrestling entertainment (if ticking yes, fill in box D)
- e) live music (if ticking yes, fill in box E)
- f) recorded music (if ticking yes, fill in box F)
- g) performances of dance (if ticking yes, fill in box G)
- h) anything of a similar description to that falling within (e), (f) or (g) (if ticking yes, fill in box H)

**Provision of entertainment facilities:**

- i) making music (if ticking yes, fill in box I)
- j) dancing (if ticking yes, fill in box J)
- k) entertainment of a similar description to that falling within (i) or (j)  
(if ticking yes, fill in box K)

**Provision of late night refreshment** (if ticking yes, fill in box L)

**Supply of alcohol** (if ticking yes, fill in box M)

**In all cases complete boxes N, O and P**



**M**

<b>Supply of alcohol</b> Standard days and timings (please read guidance note 6)			<b>Will the supply of alcohol be for consumption</b> <b>(Please tick box)</b> (please read guidance note 7)	On the premises	<input type="checkbox"/>			
				Off the premises	<input checked="" type="checkbox"/>			
				Both	<input type="checkbox"/>			
Day	Start	Finish	<b>State any seasonal variations for the supply of alcohol</b> (please read guidance note 4) <i>NO</i>					
Mon	9.00	23.00						
Tue	9.00	23.00						
Wed	9.00	23.00						
Thur	9.00	23.00				<b>Non standard timings. Where you intend to use the premises for the supply of alcohol at different times to those listed in the column on the left, please list</b> (please read guidance note 5) <i>NO</i>		
Fri	9.00	23.00						
Sat	9.00	23.00						
Sun	9.00	23.00						

State the name and details of the individual whom you wish to specify on the licence as premises supervisor

Name	TAMIL CHELVI VIJAYAN
Address	23 ASH CLOSE COLDEN COMMON SO21 1AL.
Postcode	SO21 1AL
Personal Licence number (if known)	11/00709/LIPERS
Issuing licensing authority (if known)	LONDON BOROUGH OF CROYDON

**N**

**Please highlight any adult entertainment or services, activities, other entertainment or matters ancillary to the use of the premises that may give rise to concern in respect of children (please read guidance note 8)**

NO

**O**

<b>Hours premises are open to the public</b> Standard days and timings (please read guidance note 6)			<b>State any seasonal variations</b> (please read guidance note 4)
Day	Start	Finish	
Mon	7.00	23.00	<p><b>Non standard timings. Where you intend the premises to be open to the public at different times from those listed in the column on the left, please list</b> (please read guidance note 5)</p>
Tue	7.00	23.00	
Wed	7.00	23.00	
Thur	7.00	23.00	
Fri	7.00	23.00	
Sat	7.00	23.00	
Sun	7.00	23.00	

**P** Describe the steps you intend to take to promote the four licensing objectives:

**a) General – all four licensing objectives (b,c,d,e) (please read guidance note 9)**

We will sell our customers without making any disturbance for our neighbours also we will watch outside of the premises any our drinking or do any disturbance we will inform to the ~~Police~~ <sup>People</sup>.

**b) The prevention of crime and disorder**

Good staff training and also have CCTV Record 24 hours It keep the record for 30 days and available suitable format for police.

**c) Public safety**

We have trained staffs and equipments to ~~safe~~ <sup>protect</sup> public from the harm situation.

**d) The prevention of public nuisance**

We are not making any loud noise like radio, CD Player and also any group of people Example Youth Advised to be not making any noise around the premises.

**e) The protection of children from harm**

Challenge any 21, Ask ID and Training the staffs how to challenge the situation.

Please tick yes

- I have made or enclosed payment of the fee
- I have enclosed the plan of the premises
- I have sent copies of this application and the plan to responsible authorities and others where applicable
- I have enclosed the consent form completed by the individual I wish to be premises supervisor, if applicable
- I understand that I must now advertise my application
- I understand that if I do not comply with the above requirements my application will be rejected

**IT IS AN OFFENCE, LIABLE ON CONVICTION TO A FINE UP TO LEVEL 5 ON THE STANDARD SCALE, UNDER SECTION 158 OF THE LICENSING ACT 2003 TO MAKE A FALSE STATEMENT IN OR IN CONNECTION WITH THIS APPLICATION**

**Part 4 – Signatures** (please read guidance note 10)

**Signature of applicant or applicant’s solicitor or other duly authorised agent** (See guidance note 11). If signing on behalf of the applicant please state in what capacity.

Signature	
Date	16/08/2011
Capacity	PROPRIETOR

**For joint applications signature of 2<sup>nd</sup> applicant or 2<sup>nd</sup> applicant’s solicitor or other authorised agent.** (please read guidance note 12). If signing on behalf of the applicant please state in what capacity.

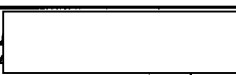
Signature	
Date	
Capacity	

**Contact name (where not previously given) and postal address for correspondence associated with this application** (please read guidance note 13)

Post town		Post code	
Telephone number (if any)			
If you would prefer us to correspond with you by e-mail your e-mail address (optional)			

SUNSTAR CONVENIENCE STORE  
SHOP 1. THE OLD POST OFFICE,  
S021 1RP.

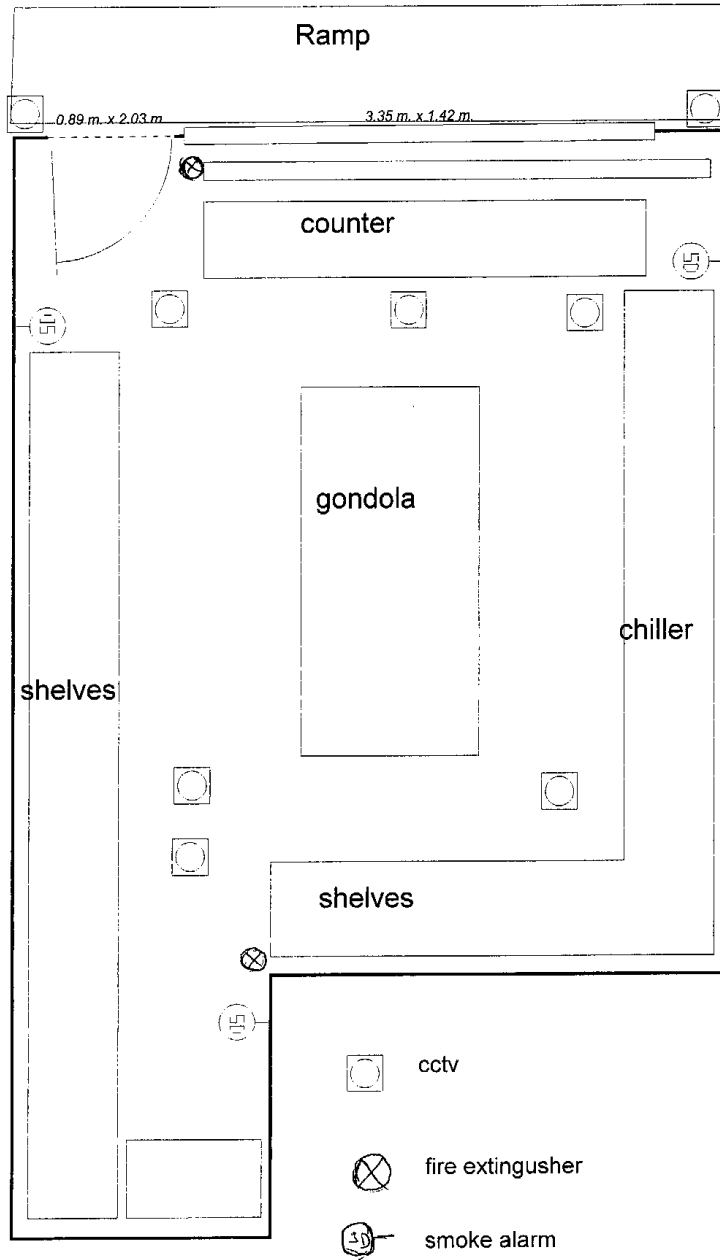

layout with shelves gondola  
and counter

## Appendix 2

This is to register my objection to the application for extended hours 7 days weekly at these premises, for the following reasons:

- 1, My flat is ground floor and my bedroom backs on to the back of the shop. My concerns mainly relate to noise and store traffic
- 2.. There appears to be little or no sound-proofing between the shop and my bedroom - the layout of which offers me no choice but to have my headboard on the shared wall.
3. My bedroom windows are directly on to the shared/communal entrance road - and it is inevitable that shoppers will use this road in order to visit the shop - this will be very noisy and disruptive to me, especially at night.
4. I have been diagnosed with terminal cancer (evidence available if required) - I therefore am in bed much of the time and sleeping at various times during the day
5. There is no allocated parking at the front for shop customers - so drivers will undoubtedly block entry road, park directly outside my bedroom windows - slam car doors on arrival/departure as well as cause obstruction on main road outside shop.

Thank you, please register my concerns.

Sheila J Mitchell  
1 The Old Post Office  
Main Road  
Colden Common  
Winchester  
SO21 1RP

## Appendix 2

Flat 3 The Old Post Office  
49 Main Road  
Colden Common  
Hampshire  
SO21 1RP  
8<sup>th</sup> September 2011

Head of Legal Services  
Winchester City Council  
City Offices  
Colebrook Street  
Winchester  
Hampshire  
SO23 9LJ

Dear Sir/Madam,

**Ref: Licensing Act 2003 Application for a Premises Licence 1 The Old Post Office, 49 Main Road, Colden Common, SO21 1RP.**

I am writing to object to the above licence application. I am a resident of the aforementioned building and am therefore defined under your Licensing Policy as a legitimate interested party being a 'person living in the vicinity of the premises in question'.

According to your document 'Guidance for Interested Parties – Making Representations' it states that the applicant must 'place a notice every 50 metres on the external perimeter of the premises abutting any highway'. This has not been completed. Furthermore, I do not believe that a notice has been placed in a local newspaper. I would therefore request to see a copy of this to be reassured that this part of the application process has indeed been carried out.

I believe that this licence should not be granted for the following reasons:

**The prevention of crime and disorder**

I would have great concerns that young people attracted to the premises would inevitably lead to an increased number of youths 'hanging around' the property. This could also increase the public nuisance at the site as indicated below. It's location across from a recreational ground will only exasperate the situation.

As per your licensing policy I believe residents should be reassured that appropriate CCTV be installed should crime and disorder occur at the premises. This is a residential property and therefore, any disorder would directly impact on us.

**Public safety**

I believe that the additional traffic at this location would cause result in increased parking and public footfall outside the building. This increased footfall is a great risk on this main road. There is no suitable parking behind the property as the adjacent road is a private drive. Importantly, it is my opinion that a Safety Advisory Group will need to be consulted to determine the impact on people stopping on the main road in their cars as there are currently no double yellow lines.

The Operating Schedule must have regard to the nature of our property. We need to know that they have considered the type of premises concerned, the licensable activities to be provided, operational procedures and the needs of the local community. As per your requirements we will need reassurance on how they intend that the premises will be "good neighbours" both to residents and to other venues and businesses.

## Appendix 2

### **Prevention of public nuisance**

I have concerns that machinery such as refrigeration equipment or air conditioning systems may cause noise disturbance. The noise produced may not be a problem during the early evening but may cause disturbance to residents of the building later at night when they are trying to sleep, i.e. after 23:00.

There is no parking for potential clients of the premises behind the property but I am confident that the public will use the private driveway to park which will not only cause a nuisance to the residents of the property but the clientele of the adjacent public house.

Flashing or bright lights from such a property would cause light pollution particularly as the living areas for the flats in the building are also on the front of the property. There are currently very few street lights therefore there would be increased light pollution from the premises.

Critically, there are no appropriate areas for a suitable refuse container. The road adjacent to the property is private and therefore a large bin cannot be stored there. There are also no suitable locations on the road. I would propose that there would be a litter issues as there are no locations to store litter at this site.

Under the Winchester City Council Licensing Policy it states that 'consideration will be given to the individual merits of an application'. I propose that the intending licensing hours are not appropriate for this residential building and area. In the least would request a modification to the licence application to reduce the hours over which the property will be open. Restriction of hours should be considered.

Residents will need to be reassured of no deliveries early morning or late at night. I believe that this is also a condition placed on any potential owners by the freeholders of the property.

I would like to question whether or not there are appropriate planning permissions in place for the hours and activities for which the application is being made. As a residential property I would doubt there would be.

To summarise, I believe that my home will be directly affected by disturbance inside and outside my premises.

Yours faithfully,

Miss Hannah C Wright



## Appendix 2

Flat 2  
The Old Post Office  
Colden Common  
SO21 1RP

31st August 2011

Dear Sir / Madam,

We are writing to object to the proposed premises license at No 1, The Old Post Office, Main Road, Colden Common.

We are in a position to object under the Licensing Act 2003, as we live in the very immediate vicinity - the residential flat directly above this property.

The grounds we feel make this application unsuitable are as follows:

**Public safety:**

There is very limited parking behind the premises, and it's location and existence is not easily found from the road - being located some way up a private drive and unpaved road adjacent to the business unit. Our concern here is that customers using the proposed business will therefore park on the road. While it is true that there are no yellow lines outside the proposed business, the road here is both narrow and very busy. The proposed business will inevitably greatly increase the volume of parking in a location that is both unsuitable and unsafe. Of particular concern is the impact on visibility of children crossing to reach the recreation ground across the road.

**Public nuisance:**

Here, to us at least, the public in question is ourselves. We are concerned in particular about the late hours (23:00 closing, 7 days a week) of the license, as the shop is directly below our property, including one of our bedrooms. Noise from customers entering and leaving, and from any radio or music source in the property itself would be highly disruptive and unacceptable at that time.

A public nuisance is also likely to result from the aforementioned parking problems - with the additional nuisance of customers parking in the other only obvious space - our private driveway - blocking access to the designated parking and that of ours and our neighbours.

**Prevention of crime and disorder; Protecting children from harm:**

The property is next door to a public house. We worry that any customers turned away by the responsible local landlord here will try immediately to purchase more alcohol less than 10 meters away for consumption off the premises, causing a potential disagreement and inevitable disorder.

Furthermore, a location directly opposite the recreation ground used by many young people will create a highly unsuitable temptation to under-age children to try and obtain alcohol to consume on the recreation ground. Even those young people who are not under age will be tempted to buy alcohol and consume it on the recreation ground, potentially leading to antisocial behaviour and even crime.

We trust the above concerns will receive your full consideration.

Regards,  
Andrew Waterman  
& Bryony Hatton

## Appendix 2

To: Mr J Myall, Legal Services, Winchester City Council  
From: Michael Blackstaff, 34 Main Road, Colden Common, Winchester SO21 1RR  
Ref: Application for Alcohol Licence by No.1 Old Post Office, 49 Main Road, Colden Common SO21 1RP

Dear Mr Myall

Thank you for your time and your comments when I phoned you a few days ago on this subject. As recommended, I have read the relevant section on your website.

Please accept this email as a formal objection to the above application on the grounds of public nuisance. There are three other alcohol-licensed shops within a mile of The Old Post Office which close at respectively 19.00, 20.00 and 22.00 The Licence applied for would be effective until 23.00 hours.

This late hour is inappropriate for what is currently a quiet residential area. As the premises would then be the latest-opening alcohol-purveying shop in the vicinity it would attract those with a mind to buy alcohol at a late hour and to consume it in the open air, especially given the proximity, immediately opposite, of an unlit recreation ground, with the consequent likelihood of disturbance and nuisance to people in the surrounding area, including my property.

I noted from our phone conversation that a hearing resulting from any objections would probably be held on the 29th September. I would have wished, if invited, to attend such a hearing but regret to advise you that I would not be available to do so on that day.

Yours sincerely

Michael Blackstaff

# 1 The Old Post Office, Colden Common

## Application for Premises Licence

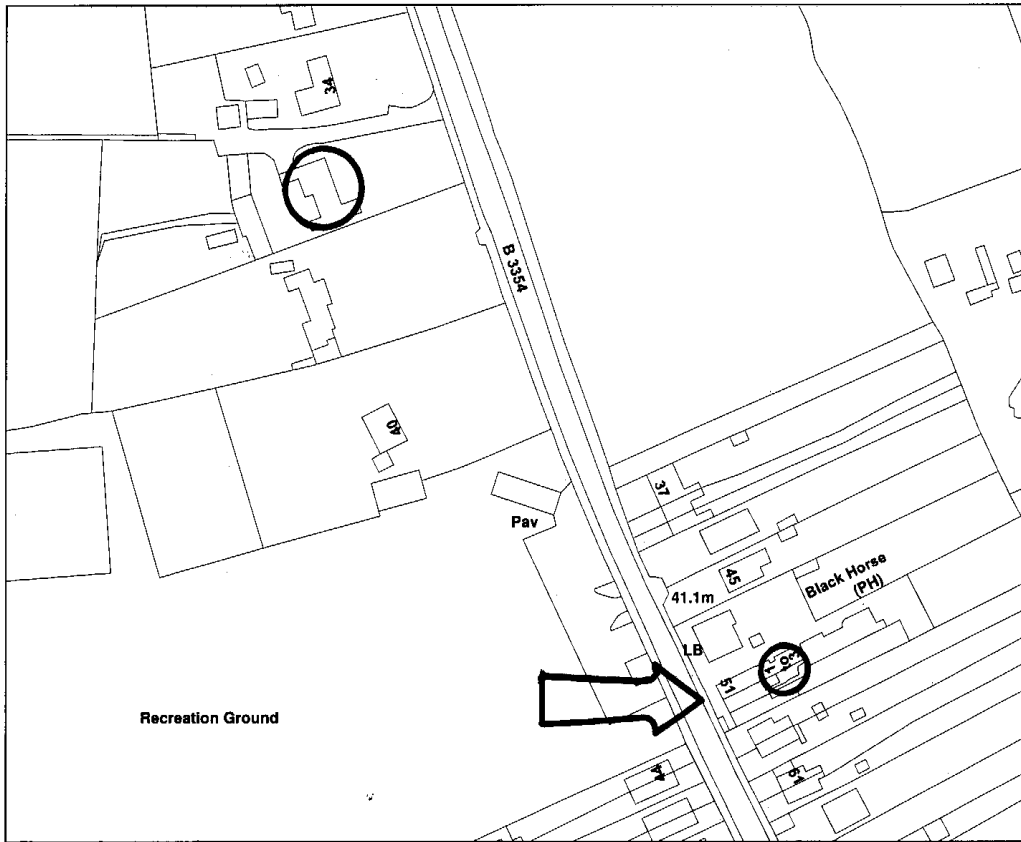

**Legend**

Scale:



Reproduced from the Ordnance Survey map with the permission of the Controller of Her Majesty's Stationery Office © Crown Copyright. Unauthorised reproduction infringes Crown Copyright and may lead to prosecution or civil proceedings. Winchester City Council © 2007.

<b>Organisation</b>	Winchester City Council
<b>Department</b>	Legal Services
<b>Comments</b>	
<b>Date</b>	21 September 2011
<b>SLA Number</b>	00018301