



<b>Meeting</b>	Licensing Sub-Committee
<b>Date and Time</b>	Thursday, 23rd April, 2026 at 10.00 am.
<b>Venue</b>	Walton Suite, Guildhall, Winchester and streamed live on YouTube at <a href="http://www.youtube.com/winchestercc">www.youtube.com/winchestercc</a>

### S U P P L E M E N T A R Y   A G E N D A

Agenda Item.

3. Application for a Variation of Premises Licence - The Rising Sun, Colden Common, Winchester, SO21 1SB (LR608) (Pages 3 - 16)

(Revised Appendix 1 to Report  
LR608 (including plan))

City Offices  
Colebrook Street  
Winchester  
SO23 9LJ

**Laura Taylor**  
**Chief Executive**

All of the Council's publicly available agendas, reports and minutes are available to view and download from the Council's [Website](#) and are also open to inspection at the offices of the council. As part of our drive to minimise our use of paper we do not provide paper copies of the full agenda pack at meetings. We do however, provide a number of copies of the agenda front sheet at the meeting which contains the QR Code opposite. Scanning this code enables members of the public to easily access all of the meeting papers on their own electronic device. Please hold your device's camera or QR code App over the QR Code so that it's clearly visible within your screen and you will be redirected to the agenda pack.



14 April 2026

Agenda Contact: Claire Buchanan, Senior Democratic Services Officer  
Tel: 01962 848 438 Email: [cbuchanan@winchester.gov.uk](mailto:cbuchanan@winchester.gov.uk)

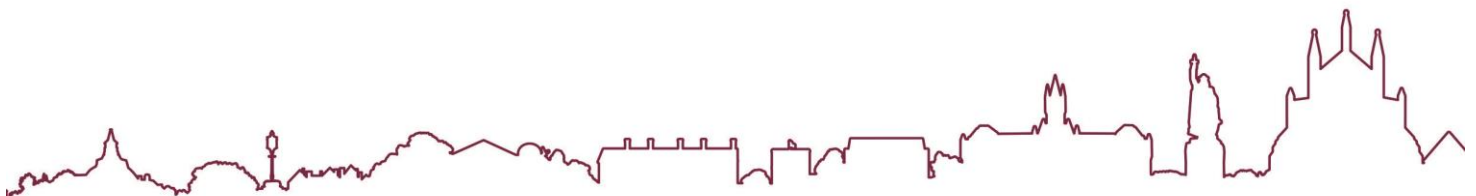

This page is intentionally left blank



**Winchester**  
**Application to vary a premises licence**  
**Licensing Act 2003**

For help contact  
[licensing@winchester.gov.uk](mailto:licensing@winchester.gov.uk)  
Telephone: 01962 840222

\* required information

## Section 1 of 18

You can save the form at any time and resume it later. You do not need to be logged in when you resume.

System reference

Not Currently In Use

This is the unique reference for this application generated by the system.

Your reference

DCC/RS/26/VAR

You can put what you want here to help you track applications if you make lots of them. It is passed to the authority.

Are you an agent acting on behalf of the applicant?

Yes  No

Put "no" if you are applying on your own behalf or on behalf of a business you own or work for.

### Applicant Details

\* First name

Jonathon

\* Family name

Spencer

\* E-mail

Main telephone number

Include country code.

Other telephone number

Indicate here if the applicant would prefer not to be contacted by telephone

Is the applicant:

Applying as a business or organisation, including as a sole trader  
 Applying as an individual

A sole trader is a business owned by one person without any special legal structure. Applying as an individual means the applicant is applying so the applicant can be employed, or for some other personal reason, such as following a hobby.

### Applicant Business

Is the applicant's business registered in the UK with Companies House?

Yes  No

Note: completing the Applicant Business section is optional in this form.

Registration number

14602380

Business name

Lucky Hoof 2023 Ltd

If the applicant's business is registered, use its registered name.

VAT number

-

Put "none" if the applicant is not registered for VAT.

Legal status

Private Limited Company

**Continued from previous page...**

Applicant's position in the business

Home country

The country where the applicant's headquarters are.

**Registered Address**

Address registered with Companies House.

Building number or name

Street

District

City or town

County or administrative area

Postcode

Country

**Agent Details**

\* First name

\* Family name

\* E-mail

Main telephone number

Include country code.

Other telephone number

Indicate here if you would prefer not to be contacted by telephone

Are you:

An agent that is a business or organisation, including a sole trader

A sole trader is a business owned by one person without any special legal structure.

A private individual acting as an agent

**Agent Business**

Is your business registered in the UK with Companies House?  Yes  No

Note: completing the Applicant Business section is optional in this form.

Registration number

Business name

If your business is registered, use its registered name.

VAT number

Put "none" if you are not registered for VAT.

Legal status

*Continued from previous page...*

Your position in the business

Home country

The country where the headquarters of your business is located.

**Agent Registered Address**

Address registered with Companies House.

Building number or name

Street

District

City or town

County or administrative area

Postcode

Country

**Section 2 of 18**

**APPLICATION DETAILS**

**This application cannot be used to vary the licence so as to extend the period for which the licence has effect or to vary substantially the premises to which it relates. If you wish to make that type of change to the premises licence, you should make a new premises licence application under section 17 of the Licensing Act 2003.**

I/we, as named in section 1, being the premises licence holder, apply to vary a premises licence under section 34 of the Licensing Act 2003 for the premises described in section 2 below.

\* Premises Licence Number

Are you able to provide a postal address, OS map reference or description of the premises?

- Address     OS map reference     Description

**Postal Address Of Premises**

Building number or name

Street

District

City or town

County or administrative area

Postcode

Country

**Premises Contact Details**

Telephone number

Continued from previous page...

Non-domestic rateable value of premises (£)

13,750

### Section 3 of 18

#### VARIATION

Do you want the proposed variation to have effect as soon as possible?  Yes  No

Do you want the proposed variation to have effect in relation to the introduction of the late night levy?

Yes  No

You do not have to pay a fee if the only purpose of the variation for which you are applying is to avoid becoming liable to the late night levy.

If your proposed variation would mean that 5,000 or more people are expected to attend the premises at any one time, state the number expected to attend

#### Describe Briefly The Nature Of The Proposed Variation

Describe the premises. For example the type of premises, its general situation and layout and any other information which could be relevant to the licensing objectives. Where your application includes off-supplies of alcohol and you intend to provide a place for consumption of these off-supplies, you must include a description of where the place will be and its proximity to the premises.

Increase licensable area following an extension to the premises, pursuant to the grant of a planning application in 2025.

Modification of conditions of licence as set out in sections 15 and 16 of this application. Some conditions modified to reflect amended layout and structure of premises.

### Section 4 of 18

#### PROVISION OF PLAYS

[See guidance on regulated entertainment](#)

Will the schedule to provide plays be subject to change if this application to vary is successful?

Yes  No

### Section 5 of 18

#### PROVISION OF FILMS

[See guidance on regulated entertainment](#)

Will the schedule to provide films be subject to change if this application to vary is successful?

Yes  No

### Section 6 of 18

#### PROVISION OF INDOOR SPORTING EVENTS

Continued from previous page...

[See guidance on regulated entertainment](#)

Will the schedule to provide indoor sporting events be subject to change if this application to vary is successful?

- Yes  No

**Section 7 of 18**

**PROVISION OF BOXING OR WRESTLING ENTERTAINMENTS**

[See guidance on regulated entertainment](#)

Will the schedule to provide boxing or wrestling entertainments be subject to change if this application to vary is successful?

- Yes  No

**Section 8 of 18**

**PROVISION OF LIVE MUSIC**

[See guidance on regulated entertainment](#)

Will the schedule to provide live music be subject to change if this application to vary is successful?

- Yes  No

**Section 9 of 18**

**PROVISION OF RECORDED MUSIC**

[See guidance on regulated entertainment](#)

Will the schedule to provide recorded music be subject to change if this application to vary is successful?

- Yes  No

**Section 10 of 18**

**PROVISION OF PERFORMANCES OF DANCE**

[See guidance on regulated entertainment](#)

Will the schedule to provide performances of dance be subject to change if this application to vary is successful?

- Yes  No

**Section 11 of 18**

**PROVISION OF ANYTHING OF A SIMILAR DESCRIPTION TO LIVE MUSIC, RECORDED MUSIC OR PERFORMANCES OF DANCE**

[See guidance on regulated entertainment](#)

Will the schedule to provide anything similar to live music, recorded music or performances of dance be subject to change if this application to vary is successful?

- Yes  No

**Section 12 of 18**

**PROVISION OF LATE NIGHT REFRESHMENT**

Continued from previous page...

Will the schedule to provide late night refreshment be subject to change if this application to vary is successful?

Yes  No

**Section 13 of 18**

**SUPPLY OF ALCOHOL**

Will the schedule to supply alcohol be subject to change if this application to vary is successful?

Yes  No

**Section 14 of 18**

**ADULT ENTERTAINMENT**

Highlight any adult entertainment or services, activities, or other entertainment or matters ancillary to the use of the premises that may give rise to concern in respect of children.

Provide information about anything intended to occur at the premises or ancillary to the use of the premises which may give rise to concern in respect of children, regardless of whether you intend children to have access to the premises, for example (but not exclusively) nudity or semi-nudity, films for restricted age groups etc gambling machines etc.

N/A

**Section 15 of 18**

**HOURS PREMISES ARE OPEN TO THE PUBLIC**

**Standard Days And Timings**

MONDAY

Start

End

Start

End

Provide timings in 24 hour clock (e.g., 16:00) and only give details for the days of the week when you intend the premises to be used for the activity.

TUESDAY

Start

End

Start

End

WEDNESDAY

Start

End

Start

End

THURSDAY

Start

End

Start

End

FRIDAY

Start

End

Start

End

Continued from previous page...

SATURDAY

Start

End

Start

End

SUNDAY

Start

End

Start

End

State any seasonal variations.

For example (but not exclusively) where the activity will occur on additional days during the summer months.

Non standard timings. Where you intend to use the premises to be open to the members and guests at different times from those listed above, list below.

For example (but not exclusively), where you wish the activity to go on longer on a particular day e.g. Christmas Eve.

Identify those conditions currently imposed on the licence which you believe could be removed as a consequence of the proposed variation you are seeking.

Removal of all conditions currently under Annex 2 of the premises licence, to be replaced by proposed conditions contained in section 16 of this application.

- I have enclosed the premises licence
- I have enclosed the relevant part of the premises licence

Reasons why I have failed to enclose the premises licence or relevant part of premises licence.

Not to hand

**Section 16 of 18**

**LICENSING OBJECTIVES**

Describe the steps you intend to take to promote the four licensing objectives:

a) General – all four licensing objectives (b,c,d,e)

List here steps you will take to promote all four licensing objectives together.

*Continued from previous page...*

1. CCTV- internal and external CCTV shall be installed, with footage retained for a minimum of 28 days and made available to responsible authorities upon request.
2. An incident book must be kept at the Premises and maintained up to date (no later than 24 hours after the incident) at all times and will record the following:
  - i. Time date and details of all incidents/complaints of crime and disorder or anti-social behaviour
  - ii. All crimes reported to the venue
  - iii. Any faults in the CCTV system, searching equipment or scanning equipment
  - iv. Any visit by a responsible authority or emergency serviceThe incident book must be kept at the premises and made available to an Officer of a Responsible Authority on request, or during an inspection.
3. A refusals register must be kept at the Premises and maintained up to date at all times recording the date time, type of product refused, reasons for every refusal to sell alcohol to a customer and the name and signature of member of staff refusing the sale. The refusals record must be made available to an Officer of a Responsible Authority on request. The Premises Licence Holder or the Designated Premises Supervisor must monitor the Refusals Register every month and must sign and date the Refusals Register when this has been completed, or if the Refusals Register is electronic the check and date and time of the check must be clearly recorded.
4. Training in relation to the Licensing Objectives and the conditions on the premises licence, Challenge 25, under age sales, sales to adults on behalf of minor (proxy sales), sales to intoxicated persons, refusals registers, incident records dispersal policy, the premises' drugs policy must be provided and undertaken by all members of staff (whether paid or unpaid) before he / she makes a sale or supply of alcohol and at least every six months thereafter. Documented training records must be completed in respect of every member of staff and must include the name of the member of staff trained, date, time and content of the training. The record must be signed by the member of staff who has received the training, the Designated Premises Supervisor, the Premises Licence Holder or external training providers. Documented training records must be kept at the premises and made available to an Officer of a Responsible Authority on request.

b) The prevention of crime and disorder

c) Public safety

d) The prevention of public nuisance

5. The areas denoted smoking area and hatched in green on the plan that accompanies this application shall by the only area used by patrons for smoking.
6. No alcohol shall be taken outside of the premises after 22:30 hours.
7. All windows and doors shall be kept closed (other than for access and egress) when regulated entertainment is being performed.
8. The premises shall deploy its best efforts to prevent patrons loitering in the outside area of the premises after 22:30 hours.

*Continued from previous page...*

9. No television set shall be used in the external wooden gazebo type structure situated in the area marked 'Gazebo Area' and hatched in blue on the plan that accompanies this application, or any other screen projecting television images, and nor shall any loudspeakers be used in this area.

10. The Licence Holder shall install noise attenuating baffleboard materials to the external wooden gazebo structure situated in the area marked 'Gazebo Area' and hatched in blue in the plan that accompanies this application.

11. Noise Management Plan ('NMP'): The premises shall operate in accordance with a NMP to be agreed with the Licensing Authority. The Premises Licence holder shall ensure that the premises operates in accordance with the approved NMP.

12. There shall be included in the NMP a patron dispersal policy from the premises to minimise noise disturbance to nearby residents after 22:30 hours. The policy shall be agreed with the Local Authority.

13. The provision of live/ recorded music at the Premises shall no longer be exempt from licensing requirements under the Live Music Act 2012. Accordingly, any performance of live/ recorded music shall be subject to the conditions of this Premises Licence and shall not take place unless specifically authorised by this Licence.

14. There shall be a maximum of three live music events per annum outside of the licensed premises. Such events must not be consecutive and last for a maximum duration of 4 hours, to finish no later than 20:00 hours.

15. Amplification of live music events outside the premises shall be by microphone only and shall not be by use of amplified instruments.

16. There shall be signage positioned in prominent locations inside and outside the premises, particularly at exit points and paths, reminding patrons to respect the needs of residents and to leave quietly.

17. The Licence Holder will not accept deliveries to the premises before 08:00 hours each day of the week.

18. The Licence Holder shall provide to local residents a dedicated telephone number or email address to enable the premises staff at any time or day the premises are open to respond to any complaints alleging public nuisance. A written log book shall be kept of any complaints with times and dates together with the nature of the complaint and action taken. The log book should be available at all times to responsible authorities for inspection.

e) The protection of children from harm

19. The Licence Holder shall adopt the Challenge 25 scheme and appropriate signage will be placed at the bar servery. The premises will operate a policy whereby any person attempting to buy alcohol who appears to be under 25 will be asked for photographic ID to prove their age. The ID that will be accepted is a passport or driving licence with a photograph.

**Section 17 of 18**

**NOTES ON REGULATED ENTERTAINMENT**

**Continued from previous page...**

In terms of specific **regulated entertainments** please note that:

- **Plays:** no licence is required for performances between 08:00 and 23.00 on any day, provided that the audience does not exceed 500.
- **Films:** no licence is required for 'not-for-profit' film exhibition held in community premises between 08.00 and 23.00 on any day provided that the audience does not exceed 500 and the organiser (a) gets consent to the screening from a person who is responsible for the premises; and (b) ensures that each such screening abides by age classification ratings.
- **Indoor sporting events:** no licence is required for performances between 08.00 and 23.00 on any day, provided that the audience does not exceed 1000.
- **Boxing or Wrestling Entertainment:** no licence is required for a contest, exhibition or display of Greco-Roman wrestling, or freestyle wrestling between 08.00 and 23.00 on any day, provided that the audience does not exceed 1000. Combined fighting sports – defined as a contest, exhibition or display which combines boxing or wrestling with one or more martial arts – are licensable as a boxing or wrestling entertainment rather than an indoor sporting event.
- **Live music:** no licence permission is required for:
  - o a performance of unamplified live music between 08.00 and 23.00 on any day, on any premises.
  - o a performance of amplified live music between 08.00 and 23.00 on any day on premises authorised to sell alcohol for consumption on those premises, provided that the audience does not exceed 500.
  - o a performance of amplified live music between 08.00 and 23.00 on any day, in a workplace that is not licensed to sell alcohol on those premises, provided that the audience does not exceed 500.
  - o a performance of amplified live music between 08.00 and 23.00 on any day, in a church hall, village hall, community hall, or other similar community premises, that is not licensed by a premises licence to sell alcohol, provided that (a) the audience does not exceed 500, and (b) the organiser gets consent for the performance from a person who is responsible for the premises.
  - o a performance of amplified live music between 08.00 and 23.00 on any day, at the non-residential premises of (i) a local authority, or (ii) a school, or (iii) a hospital, provided that (a) the audience does not exceed 500, and (b) the organiser gets consent for the performance on the relevant premises from: (i) the local authority concerned, or (ii) the school or (iii) the health care provider for the hospital.
- **Recorded Music:** no licence permission is required for:
  - o any playing of recorded music between 08.00 and 23.00 on any day on premises authorised to sell alcohol for consumption on those premises, provided that the audience does not exceed 500.
  - o any playing of recorded music between 08.00 and 23.00 on any day, in a church hall, village hall, community hall, or other similar community premises, that is not licensed by a premises licence to sell alcohol, provided that (a) the audience does not exceed 500, and (b) the organiser gets consent for the performance from a person who is responsible for the premises.
  - o any playing of recorded music between 08.00 and 23.00 on any day, at the non-residential premises of (i) a local authority, or (ii) a school, or (iii) a hospital, provided that (a) the audience does not exceed 500, and (b) the organiser gets consent for the performance on the relevant premises from: (i) the local authority concerned, or (ii) the school proprietor or (iii) the health care provider for the hospital.

**Continued from previous page...**

- Dance: no licence is required for performances between 08.00 and 23.00 on any day, provided that the audience does not exceed 500. However, a performance which amounts to adult entertainment remains licensable.
- Cross activity exemptions: no licence is required between 08.00 and 23.00 on any day, with no limit on audience size for:
  - o any entertainment taking place on the premises of the local authority where the entertainment is provided by or on behalf of the local authority;
  - o any entertainment taking place on the hospital premises of the health care provider where the entertainment is provided by or on behalf of the health care provider;
  - o any entertainment taking place on the premises of the school where the entertainment is provided by or on behalf of the school proprietor; and
  - o any entertainment (excluding films and a boxing or wrestling entertainment) taking place at a travelling circus, provided that (a) it takes place within a moveable structure that accommodates the audience, and (b) that the travelling circus has not been located on the same site for more than 28 consecutive days.

**Section 18 of 18**

**PAYMENT DETAILS**

This fee must be paid to the authority. If you complete the application online, you must pay it by debit or credit card.

Variation Fees are determined by the non-domestic rateable value of the premises.

To find out a premises non domestic rateable value go to the Valuation Office Agency site at [http://www.voa.gov.uk/business\\_rates/index.htm](http://www.voa.gov.uk/business_rates/index.htm)

Band A - No RV to £4300 £100.00

Band B - £4301 to £33000 £190.00

Band C - £33001 to £8700 £315.00

Band D - £87001 to £12500 £450.00\*

Band E - £125001 and over £635.00\*

\*If the premises rateable value is in Bands D or E and the premises is primarily used for the consumption of alcohol on the premises then you are required to pay a higher fee

Band D - £87001 to £12500 £900.00

Band E - £125001 and over £1,905.00

If you own a large premise you are subject to additional fees based upon the number in attendance at any one time

Capacity 5000-9999 £1,000.00

Capacity 10000 -14999 £2,000.00

Capacity 15000-19999 £4,000.00

Capacity 20000-29999 £8,000.00

Capacity 30000-39000 £16,000.00

Capacity 40000-49999 £24,000.00

Capacity 50000-59999 £32,000.00

Capacity 60000-69999 £40,000.00

Capacity 70000-79999 £48,000.00

Capacity 80000-89999 £56,000.00

Capacity 90000 and over £64,000.00

\* Fee amount (£)

190.00

**ATTACHMENTS**

**AUTHORITY POSTAL ADDRESS**

Continued from previous page...

**Address**

Building number or name	<input type="text"/>
Street	<input type="text"/>
District	<input type="text"/>
City or town	<input type="text"/>
County or administrative area	<input type="text"/>
Postcode	<input type="text"/>
Country	<input type="text" value="United Kingdom"/>

**DECLARATION**

\* I/we understand it is an offence, liable on conviction to a fine up to level 5 on the standard scale, under section 158 of the licensing act 2003, to make a false statement in or in connection with this application.

Ticking this box indicates you have read and understood the above declaration

This section should be completed by the applicant, unless you answered "Yes" to the question "Are you an agent acting on behalf of the applicant?"

* Full name	<input type="text"/>
* Capacity	<input type="text"/>
Date (dd/mm/yyyy)	<input type="text"/>

Once you're finished you need to do the following:

1. Save this form to your computer by clicking file/save as...
2. Go back to <https://www.gov.uk/apply-for-a-licence/premises-licence/winchester/change-1> to upload this file and continue with your application.

Don't forget to make sure you have all your supporting documentation to hand.

**IT IS AN OFFENCE, UNDER SECTION 158 OF THE LICENSING ACT 2003, TO MAKE A FALSE STATEMENT IN OR IN CONNECTION WITH THIS APPLICATION. THOSE WHO MAKE A FALSE STATEMENT MAY BE LIABLE ON SUMMARY CONVICTION TO A FINE OF ANY AMOUNT.**

# DUNCAN CRAIG

## DRAWING LEGEND

### THE RISING SUN

27 Spring Lane, Colden Common, Winchester, SO21 1SB  
 Date: 5th February 2026 (A2) Drawing Scale: 1:100  
 Drawn By: Alex Colley

#### FIRE ALARM SYSTEM:

- COMBINED STANDALONE SOUNDER & FLASHING BEACON
- BREAK GLASS CALL POINT
- HEAT DETECTOR
- HEAT DETECTOR C/W BEACON & SOUNDER BASE
- HEAT DETECTOR C/W SOUNDER BASE
- COMBINED HEAT/SMOKE DETECTOR
- COMBINED HEAT/SMOKE DETECTOR C/W BEACON & SOUNDER BASE
- COMBINED HEAT/SMOKE DETECTOR C/W SOUNDER BASE
- SMOKE DETECTOR
- SMOKE DETECTOR C/W BEACON & SOUNDER BASE
- SMOKE DETECTOR C/W SOUNDER BASE

#### EMERGENCY LIGHTING LAYOUT:

- EMERGENCY LIGHT C/W DIRECTIONAL LEGEND
  - EMERGENCY LIGHTING
  - EXTERNAL EMERGENCY LIGHTING
- #### EMERGENCY SIGNAGE:
- EMERGENCY EXIT DIRECTIONAL LEGEND
- #### FIRE SAFETY:
- FIRE EXTINGUISHER - FOAM
  - FIRE EXTINGUISHER - CO2
  - FIRE BLANKET
- #### AREA OUTLINING:
- INTERNAL LICENSED AREA (170.1 m2)
  - PAULION & REAR GARDEN (68.09 m2)
  - SMOKING AREA (71.8 m2)
  - FIXED FURNITURE:



These drawings are for planning use only. The drawing legend and items have been developed to represent the existing / proposed alterations which are to be implemented to comply with planning laws verified by the borough. Specifications are to be confirmed by applicant, please contact initial designs if you are unsure of any information which has been included within the planning application.

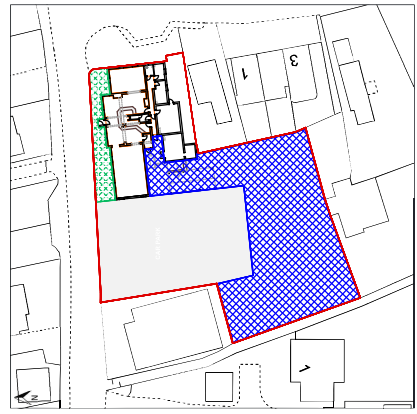
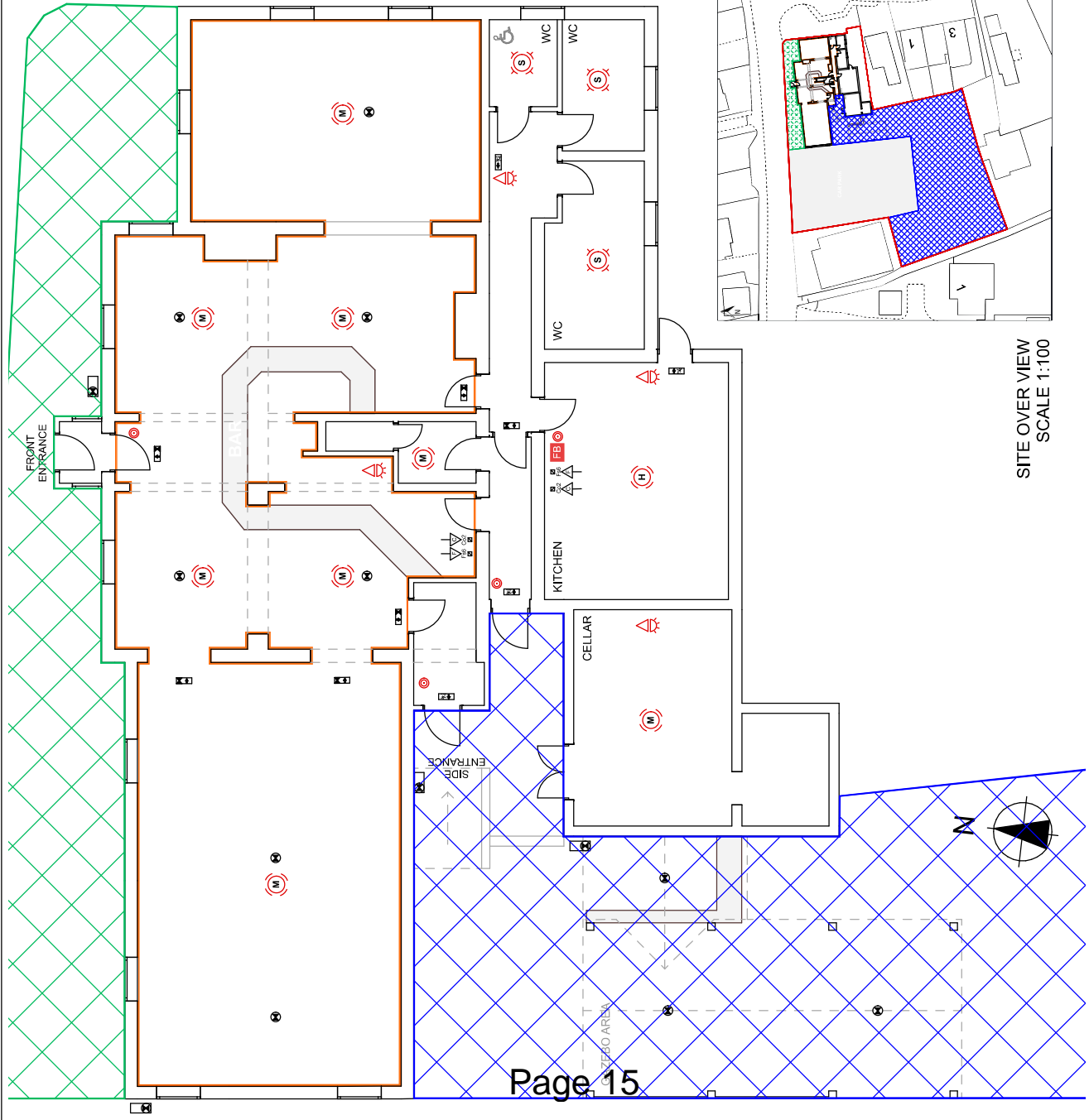
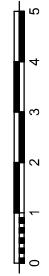

SITE OVER VIEW  
SCALE 1:100

This page is intentionally left blank