



Meeting Licensing Sub-Committee
Date and Time Tuesday, 3rd March, 2020 at 10.00 am.
Venue Walton Suite, Guildhall, Winchester

AGENDA

1. **New Premises Licence - Kassia Lounge, Hambledon Road, Denmead, Hampshire, PO7 6NU (LR531) (Pages 5 - 82)**

Lisa Kirkman
Strategic Director: Resources and Monitoring Officer

24 February 2020

Agenda Contact: Claire Buchanan, Senior Democratic Services Officer
Tel: 01962 848 438 Email: cbuchanan@winchester.gov.uk

The Membership of the Sub-Committee will be:

Cllrs Green (Chairman), Bentote and Gordon-Smith
Reserve Member: Cllr Laming

Appointments - The Sub-Committee consists of a Chairperson and two other Members who are appointed on a rota basis from the membership of the full Licensing and Regulation Committee, subject to availability. Four Members of the Committee have been nominated as Chairpersons for the sub-committee and are also appointed on a rota basis.

For information, the Membership of the Licensing and Regulation Committee is:
Councillors: Bentote, Achwal, Clementson, Cook, Fern, Gemmell, Gordon-Smith, Green, Laming, Mather and Williams (deputies: Cllrs Clear, McLean, Power and Read)

Filming and Broadcast Notification

This meeting may be recorded and broadcast live on the Council's website. The meeting may also be recorded and broadcast by the press and members of the public – please see the Access to Information Procedure Rules within the Council's Constitution for further information, which is available to view on the [Council's website](http://www.winchester.gov.uk).

Licensing Sub Committee - Procedure for Hearing Applications for Premises Licences and Club Premises Certificates

In accordance with the Licensing Act 2003 (Hearings) Regulations 2005, the hearing will take the form of a discussion led by the Sub-Committee. Cross-examination will not be permitted unless the Sub-Committee considers it necessary to properly consider the matter.

Written objections, representations and petitions will be circulated with the Agenda and Report and will be taken into account by Members of the Sub-Committee. Only those who have made "relevant representations" within the meaning of the Licensing Act 2003 will be entitled to be heard as of right by the Sub-Committee.

1. The **Chairperson** will set out the procedure to be followed during the hearing
2. **The Licensing Manager** will introduce the Report.
3. **Members** of the Sub-Committee may ask questions of the **Licensing Manager**.
4. The **Applicant** or representative may address the Sub-Committee as follows:- a) to clarify any points which the Licensing Authority has given notice of (Regulation 7(1)(d) of the Licensing Act 2003 (Hearings) Regulations 2005; b) to address the Sub-Committee and present the application.
5. **Members** of the Sub-Committee may ask questions of the **Applicant** or representative

Responsible Authorities who have made representations will then be allowed to introduce their representations. The Sub-Committee may ask them questions, and (subject to the permission of the Sub-Committee) the Applicant or representative may ask them questions.

6. **Environmental Health Officer**
7. **Police**
8. **Fire Service**
9. **Child Protection Team**
10. **Local Planning Authority**
11. **Health and Safety Executive**
12. **Trading Standards**
13. **NHS Public Health Manager**
14. **Licensing Authority**

Persons who have made Relevant Representations (within the meaning of the Licensing Act 2003) will then be allowed to introduce their representations. The Sub-Committee may ask them questions, and (subject to the permission of the Sub-Committee) the Applicant or representative may ask them questions.

15. **Persons making Relevant Representations**
16. The **Applicant** or representative may address the Sub-Committee in order to reply to any representation made.

17. **Members** of the Sub-Committee may ask questions of the **Applicant** or representative

The Sub-Committee will retire to consider the application in private with only the Head of Legal Services' representative and Democratic Services Officer in attendance. The Committee will reach its determination and notify the applicant of the decision, and give reasons for that decision, in accordance with Regulations 26 – 29 of the Licensing Act 2003 (Hearings) Regulations 2005.

This page is intentionally left blank

LR531
FOR DECISION
WARD(S): DENMEAD

LICENSING SUB – COMMITTEE

Tuesday 3 March 2020 10:00 at Guildhall Winchester

Report of the Service Lead for Public Protection

Contact Officer: Ian Myers
Tel No: 01962 848 188
Email: imyers@winchester.gov.uk

Application: Application for a New Premises Licence

Premises: Kassia Lounge, Crawford House, Hambledon Road, Denmead,
PO7 6NU

Part A. Report

- 1 Application**
- 2 Responsible Authorities**
- 3 Other Representations**
- 4 Observations**
- 5 Conditions**
- 6 Other Considerations**

Part B. Appendices

- Appendix 1 Application**
- Appendix 2 Representations from Responsible Authorities**
- Appendix 3 Representations from Other Persons**
- Appendix 4 Map of premises location/representations**

Part A.**1. Application****Applicant:** Fasu Miah**Premises:** Kassia Lounge
Crawford House
Hambledon Road
Denmead
PO7 6NU

1.1 This report is to consider an application for a New Premises Licence under section 17 of the Licensing Act 2003 for Kassia Lounge, Crawford House, Hambledon Road, Denmead, PO7 6NU. The premises is a retail unit surrounded by residential properties.

1.2 The application describes the premises as a restaurant and bar serving Indian food and seeks to provide the following licensable activities at the following times:

Live Music	Monday to Sunday	1100 to 0000
	Christmas Eve	1100 to 0300
	New Years Eve	1100 to 0300
Recorded Music	Sunday to Thursday	0900 to 0000
	Friday and Saturday	0900 to 0030
	Christmas Eve	0900 to 0300
	New Years Eve	0900 to 0300
Late night refreshment	Sunday to Thursday	2300 to 0000
	Friday and Saturday	2300 to 0100
	Christmas Eve	2300 to 0300
	New Years Eve	2300 to 0300
Sale of alcohol (on and off the premises)	Sunday to Thursday	0900 to 0000
	Friday and Saturday	0900 to 0100
	Christmas Eve	0900 to 0300
	New Years Eve	0900 to 0300
Opening hours	Sunday to Thursday	0900 to 0000
	Friday and Saturday	0900 to 0100

1.3 Hampshire Constabulary made a representation against this application on the grounds of the Prevention of Crime and Disorder and Protection of Children from Harm licensing objectives. During the consultation period a number of conditions were agreed between Hampshire Constabulary and the applicant, and the representation was subsequently withdrawn. These conditions are reflected in Section 5 of this report.

- 1.4 Environmental Health made a representation against this application on the ground of the Prevention of Public Nuisance licensing objective. This is shown in Appendix 2.
- 1.5 No representations were received by any other Responsible Authorities.
- 1.6 Representations have been received from 26 Other Persons, all of which are against the application. These representations are set out in Appendix 3 and primarily relate to the Prevention of Public Nuisance licensing objective.
- 1.7 Notice of the application was displayed outside of the premises for a period of 28 days until 11 February 2020, and advertised in the Petersfield Post and its sister publications which reach Denmead under their distribution list on 22 January 2020.
- 1.8 Notices of the hearing were sent to all Parties on 14 February 2020
- 1.9 **Designated Premises Supervisor**

Fasu Miah

Steps to promote the Licensing Objectives

Please see Appendix 1, Section M.

Relevant Representations

2. Responsible Authorities

All of the Responsible Authorities have been served with a copy of the application. The representations received are as follows:

Environmental Health

Sara Hayes-Arter, on behalf of Environmental Health, made a representation against the application with regard to the Prevention of Public Nuisance licensing objective. This representation is shown in Appendix 2.

Hampshire Constabulary

PC Neil Cotton, on behalf of Hampshire Constabulary, made a representation against this application on the grounds of the Prevention of Crime and Disorder and Protection of Children from Harm licensing objectives. During the consultation period a number of conditions were agreed between Hampshire Constabulary and the applicant, and the representation was subsequently withdrawn. These conditions are reflected in Section 5 of this report.

Hampshire Fire and Rescue Service

No representations received.

Child Protection Team

No representations received.

Building Control

No representations received.

Head of Trading Standards

No representations received.

Public Health Manager

No representations received.

Home Office

No representations received.

Licensing Authority

No representations received.

Planning

No representations received.

3. Representations from Other Persons

Representations have been received from 26 'Other Persons', all of which are against the application. The main concerns are with regard to the Prevention of Public Nuisance licensing objective.

Representations can be seen in Appendix 3. A map of representations in context of the premises location can be seen at Appendix 4.

4. Observations

The Sub-Committee is obliged to determine this application with a view to promoting the Licensing Objectives:

- The prevention of crime and disorder
- Public safety
- The prevention of public nuisance
- The protection of children from harm

In making its decision, the Sub-Committee is also obliged to have regard to the national Guidance and the Council's Licensing Policy.

The Sub-Committee must have regard to all of the representations.

The Sub-Committee must take such of the following steps it considers appropriate to promote the Licensing Objectives:

1. Grant the licence subject to conditions in accordance with the operating schedule (modified to such extent as the authority considers appropriate for the promotion of the licensing objectives) and the mandatory conditions;
2. exclude from the scope of the licence any of the licensable activities to which the application relates;
3. reject the application.

Terminal hours

The Sub-Committee should take account of the national Guidance and the Council's Licensing Policy with regard to terminal hours and take such steps as it considers appropriate to promote the Licensing Objectives.

(Licensing Policy Part 4, A8)

Licensing Objectives

Crime and Disorder

The Sub-Committee should consider any appropriate conditions to prevent crime and public disorder relating to the premises having regard to the operating schedule and the representations.

(Licensing Policy 1.9, 2.11, 2.17 and Part 4 Section A)

Public Safety

The Sub-Committee should consider any appropriate conditions relating to public safety having regard to the relating to the premises having regard to the operating schedule and the representations.

(Licensing Policy Part 4, B2, B3)

Public Nuisance

The Sub-Committee should consider any appropriate conditions to prevent public nuisance caused by noise pollution from the premises relating to the premises having regard to the operating schedule and the representations.

(Licensing Policy Part 4, Section C)

Protection of Children

The Sub-Committee should consider any necessary conditions for the Protection of Children relating to the premises having regard to the operating schedule and the representations.

(Licensing Policy Part 4, D6, D7)

Human Rights

It is considered that Articles 6 (right to a fair trial); 8 (right to respect for private and family life) and Article 1 of the First Protocol (right to peaceable enjoyment of possessions) may be relevant. As there is a right of appeal to the Magistrates' Court, it is considered that there would be no infringement of Article 6. Article 8 is relevant, insofar as the nearby residents could claim that this right would be infringed by disturbance from customers. This should be balanced against the applicants' right to use of their premises under Article 1 of the First Protocol. Interference with these rights is permitted, where this interference is lawful, appropriate in a democratic society, and proportionate. Likewise, the residents may argue that their rights under Article 1 of the First Protocol would be infringed. If conditions are imposed, there should be no interference with any convention rights. To the extent that any interference may occur, it would be justifiable in a democratic society, and proportionate.

5. Conditions

Mandatory Conditions

The Licensing Act 2003 (Mandatory Licensing Conditions) (Amendment) Order 2014

– effective from 1 October 2014

1. (1) The responsible person must ensure that staff on relevant premises do not carry out, arrange or participate in any irresponsible promotions in relation to the premises.
 (2) In this paragraph, an irresponsible promotion means any one or more of the following activities, or substantially similar activities, carried on for the purpose of encouraging the sale or supply of alcohol for consumption on the premises—
 - (a) games or other activities which require or encourage, or are designed to require or encourage, individuals to—
 - (i) drink a quantity of alcohol within a time limit (other than to drink alcohol sold or supplied on the premises before the cessation of the period in which the responsible person is authorised to sell or supply alcohol), or
 - (ii) drink as much alcohol as possible (whether within a times limit or otherwise);
 - (b) provision of unlimited or unspecified quantities of alcohol free or for a fixed or discounted fee to the public or to a group defined by a particular characteristic in a manner which carries a significant risk of undermining a licensing objective;
 - (c) provision of free or discounted alcohol or any other thing as a prize to encourage or reward the purchase and consumption of alcohol over a period of 24 hours or less in a manner which carried a significant risk of undermining a licensing objective;
 - (d) selling or supplying alcohol in association with promotional posters or flyers on, or in the vicinity of, the premises which can reasonably be considered to condone, encourage or glamorise anti-social behaviour or to refer to the effects of drunkenness in any favourable manner;
 - (e) dispensing alcohol directly by one person into the mouth of another (other than where that other person is unable to drink without assistance by reason of disability).
2. The responsible person must ensure that free potable water is provided on request to customers where it is reasonably available.
 3. (1) The premises licence holder or club premises certificate holder must ensure that an age verification policy is adopted in respect of the premises in relation to the sale or supply of alcohol.
 (2) The designated premises supervisor in relation to the premises licence must ensure that the supply of alcohol at the premises is carried on in accordance with the age verification policy.
 (3) The policy must require individuals who appear to the responsible person to be under 18 years of age (or such older age as may be specified in the policy) to produce on request, before being served alcohol,

- identification bearing their photograph, date of birth and either—
- (a) a holographic mark, or
 - (b) an ultraviolet feature.
4. The responsible person must ensure that—
- (a) where any of the following alcoholic drinks is sold or supplied for consumption on the premises (other an alcoholic drinks sold or supplied having been made up in advance ready for sale or supply in a securely closed container) it is available to customers in the following measures—
 - (i) beer or cider: ½ pint;
 - (ii) gin, rum, vodka or whisky: 25ml or 35ml; and
 - (iii) still wine in a glass: 125ml;
 - (b) these measures are displayed in a menu, price list or other printed material which is available to customers on the premises; and
 - (c) where a customer does not in relation to a sale of alcohol specify the quantity of alcohol to be sold, the customer is made aware that these measures are available.

Licensing Act 2003 (Mandatory Licensing Conditions) Order 2014
– effective from 28 May 2014

1. A relevant person shall ensure that no alcohol is sold or supplied for consumption on or off the premises for a price which is less than the permitted price.
2. For the purposes of the condition set out in paragraph 1-
 - (a) “duty” is to be construed in accordance with the Alcoholic Liquor Duties Act 1979;
 - (b) “permitted price” is the price found by applying the formula- **$P = D + (D \times V)$**
 where-
 - (i) **P** is the permitted price,
 - (ii) **D** is the rate of duty chargeable in relation to the alcohol as if the duty were charged on the date of the sale or supply of the alcohol, and
 - (iii) **V** is the rate of value added tax chargeable in relation to the alcohol as if the value added tax were charged on the date of the sale or supply of the alcohol;
 - (c) “relevant person” means, in relation to premises in respect of which there is in force a premises licence-
 - (i) the holder of the premises licence,
 - (ii) the designated premises supervisor (if any) in respect of such a licence, or
 - (iii) the personal licence holder who makes or authorises a supply of alcohol under such a licence;
 - (d) “relevant person” means, in relation to premises in respect of which there is in force a club premises certificate, any member or officer of the club present on the premises in a capacity which enables the member or officer to prevent the supply in question; and
 - (e) “valued added tax” means value added tax charged in accordance with the Value Added Tax Act 1994.

3. Where the permitted price given by Paragraph (b) of paragraph 2 would (apart from this paragraph) not be a whole number of pennies, the price given by that sub-paragraph shall be taken to be the price actually given by that sub-paragraph rounded up to the nearest penny.
4. (1) Sub-paragraph 2 applies where the permitted price given by Paragraph (b) of paragraph 2 on a day (“the first day”) would be different from the permitted price on the next day (“the second day”) as a result of a change to the rate of duty or value added tax.
 (2) The permitted price which would apply on the first day applies to sales or supplies of alcohol which take place before the expiry of the period of 14 days beginning on the second day.

Possible Conditions

If the application is granted, the Sub-Committee may wish to consider the following conditions to reflect the Operating Schedule:

Conditions in italics are those which have been suggested by Hampshire Constabulary, and subsequently agreed with the applicant.

Operating Hours

1. The hours the premises may be used for regulated entertainment shall be:

Live Music	Monday to Sunday	1100 to 0000
	Christmas Eve	1100 to 0300
	New Years Eve	1100 to 0300
Recorded Music	Sunday to Thursday	0900 to 0000
	Friday and Saturday	0900 to 0030
	Christmas Eve	0900 to 0300
	New Years Eve	0900 to 0300

2. The hours the premises may be used for late night refreshment shall be:

Sunday to Thursday	2300 to 0000
Friday and Saturday	2300 to 0100
Christmas Eve	2300 to 0300
New Years Eve	2300 to 0300

3. The hours the premises may be used for the sale of alcohol (on and off the premises) shall be:

Sunday to Thursday	0900 to 0000
Friday and Saturday	0900 to 0100
Christmas Eve	0900 to 0300
New Years Eve	0900 to 0300

4. The hours the premises may open for other than Licensable Activities shall be:

Sunday to Thursday	0900 to 0000
Friday and Saturday	0900 to 0100

All Licensing Objectives

- A1: *The premises licence holder shall ensure that a training package is in place in order for all staff involved with the sale or supply of alcohol to be sufficiently trained in licensing matters proportionate to their role and aware of their responsibilities. Particular attention should be paid to underage sales / ID verification and the refusal of alcohol sales to a drunk person. Records shall be kept of this training, dated and signed by the staff member and trainer. Refresher training shall be completed at least every 12 months again with documented records made and to be available for inspection by Police and other responsible authorities.*
- A2: *A written record shall be retained at each bar to show the staff that have been authorised to sell alcohol. This shall be made available to the Police and other responsible authorities on request.*
- A3: *The Designated Premises Supervisor, or an appointed deputy (who holds the written authorisation of the DPS) who also holds a personal licence, will be on the premises at all times when they are open for licensable activities.*

Crime and Disorder

- CD1: *The premises licence holder shall ensure that a refusals book / incident book or log is maintained at the premises. These records shall be retained for a minimum of 1 year and be made available to the Police and other responsible authorities upon request.*
- CD2: *The premises licence holder shall ensure that recordable CCTV is in place when licensable activity is taking place. This must be of a standard acceptable to the local Police. There shall be sufficient cameras to cover all primary public areas in addition to cameras covering the entrance, exit and external smoking areas.*
- CD3: *Imagery obtained must be retained for a minimum of 28 days on a rolling basis. This must be made available in a format that can be viewed by Police and council officials and must be given to them on request.*
- CD4: *The need for Security Industry Authority (SIA) door staff will be risk assessed for any event at the premises which deviates from the standard restaurant operation where there is a focus on alcohol sales or regulated entertainment and on any other occasion as deemed necessary by the designated premises supervisor and/or premises*

management. This risk assessment will be recorded appropriately and retained at the premises for a minimum of 12 months for authorities to review.

Public Safety

Public Nuisance

PN1: The Premises Licence Holder shall ensure that signage requesting quiet exit and respect for neighbours is displayed at the premises.

PN2: The Premises Licence Holder shall ensure that deliveries are carried out at a time and in such a manner that will cause minimal disturbance to local residents.

Protection of Children

PC1: *The premises licence holder shall ensure that a system is in place to ensure that every individual who appears to be under 25 years of age seeking to purchase or be supplied with alcohol at or from the premises, shall produce acceptable means of identification and age confirmation. Acceptable identification shall be a passport, photo driving licence or PASS accredited photo ID. If the person seeking alcohol is unable to produce acceptable means of identification, no sale or supply of alcohol will be made to or for that person.*

6. Other Considerations

Council Strategy Outcome (Relevance To:)

This report relates to the fourth Strategic Outcome; 'Improving the quality of the District's environment' by working with partners and using powers available to us to make Winchester a safe and pleasant place to live, work and visit.

Resource Implications

A statutory licence fee of £190 has been received. It is anticipated that an appropriate level of officer attendance will be provided within the existing budget.

Appendices

1. Application by Fasu Miah
2. Representations by Responsible Authorities
3. Representations by other persons
4. Map of premises location.



Application for a premises licence to be granted under the Licensing Act 2003

PLEASE READ THE FOLLOWING INSTRUCTIONS FIRST

Before completing this form please read the guidance notes at the end of the form. If you are completing this form by hand please write legibly in block capitals. In all cases ensure that your answers are inside the boxes and written in black ink. Use additional sheets if necessary.

You may wish to keep a copy of the completed form for your records.

I/We FASU MIAM c/o "KASSIA LOUNGE"
(Insert name(s) of applicant)

*UPDATED BY IM - WCC
LICENSING WITH
PERMISSION
FROM APPLICANT
- 15/01/2020*

apply for a premises licence under section 17 of the Licensing Act 2003 for the premises described in Part 1 below (the premises) and I/we are making this application to you as the relevant licensing authority in accordance with section 12 of the Licensing Act 2003

Part 1 – Premises Details

Postal address of premises or, if none, ordnance survey map reference or description <u>CRAWFORD HOUSE, HAMBLEDON ROAD, DENMEAD HAMPSHIRE</u>			
Post town	<u>PORTSMOUTH</u>	Postcode	<u>PO7 6NU</u>
Telephone number at premises (if any)			
Non-domestic rateable value of premises		<u>£ 13,578.00</u>	

Part 2 - Applicant details

Please state whether you are applying for a premises licence as Please tick as appropriate

- a) an individual or individuals * please complete section (A)
- b) a person other than an individual *
 - i as a limited company/limited liability partnership please complete section (B)
 - ii as a partnership (other than limited liability) please complete section (B)
 - iii as an unincorporated association or please complete section (B)
 - iv other (for example a statutory corporation) please complete section (B)
- c) a recognised club please complete section (B)
- d) a charity please complete section (B)
- e) the proprietor of an educational establishment please complete section (B)

- f) a health service body please complete section (B)
- g) a person who is registered under Part 2 of the Care Standards Act 2000 (c14) in respect of an independent hospital in Wales please complete section (B)
- ga) a person who is registered under Chapter 2 of Part 1 of the Health and Social Care Act 2008 (within the meaning of that Part) in an independent hospital in England please complete section (B)
- h) the chief officer of police of a police force in England and Wales please complete section (B)

* If you are applying as a person described in (a) or (b) please confirm (by ticking yes to one box below):

- I am carrying on or proposing to carry on a business which involves the use of the premises for licensable activities; or
- I am making the application pursuant to a statutory function or
- a function discharged by virtue of Her Majesty's prerogative

(A) INDIVIDUAL APPLICANTS (fill in as applicable)

Mr <input checked="" type="checkbox"/>	Mrs <input type="checkbox"/>	Miss <input type="checkbox"/>	Ms <input type="checkbox"/>	Other Title (for example, Rev)	
Surname MIAN.			First names FASU.		
Date of birth		I am 18 years old or over <input checked="" type="checkbox"/> Please tick yes			
Nationality					
Current residential address if different from premises address		CRAWFORD HOUSE (FORMERLY FLEUZATIONS) HAMBLEDON ROAD. DENMEAD.			
Post town	PORTSMOUTH		Postcode	PO7 6NU	
Daytime contact telephone number					
E-mail address (optional)					

SECOND INDIVIDUAL APPLICANT (if applicable)

Mr <input type="checkbox"/>	Mrs <input type="checkbox"/>	Miss <input type="checkbox"/>	Ms <input type="checkbox"/>	Other Title (for example, Rev)
Surname			First names	
Date of birth			I am 18 years old or over <input type="checkbox"/> Please tick yes	
Nationality				
Current postal address if different from premises address				
Post town		Postcode		
Daytime contact telephone number				
E-mail address (optional)				

(B) OTHER APPLICANTS

Please provide name and registered address of applicant in full. Where appropriate please give any registered number. In the case of a partnership or other joint venture (other than a body corporate), please give the name and address of each party concerned.

Name
Address
Registered number (where applicable)
Description of applicant (for example, partnership, company, unincorporated association etc.)
Telephone number (if any)
E-mail address (optional)

Part 3 Operating Schedule

When do you want the premises licence to start?

DD	MM	YYYY
01	08	2019

If you wish the licence to be valid only for a limited period, when do you want it to end?

DD	MM	YYYY

Please give a general description of the premises (please read guidance note 1)

RETAIL SPACE WITH TOILETS, SEATING, BAR AND KITCHEN.
 PURPOSE: RESTAURANT AND BAR. SERVING INDIAN TAPAS/FOOD

If 5,000 or more people are expected to attend the premises at any one time, please state the number expected to attend.

What licensable activities do you intend to carry on from the premises?

(please see sections 1 and 14 and Schedules 1 and 2 to the Licensing Act 2003)

Provision of regulated entertainment (please read guidance note 2)

Please tick all that apply

- a) plays (if ticking yes, fill in box A)
- b) films (if ticking yes, fill in box B)
- c) indoor sporting events (if ticking yes, fill in box C)
- d) boxing or wrestling entertainment (if ticking yes, fill in box D)
- e) live music (if ticking yes, fill in box E)
- f) recorded music (if ticking yes, fill in box F)
- g) performances of dance (if ticking yes, fill in box G)
- h) anything of a similar description to that falling within (e), (f) or (g) (if ticking yes, fill in box H)

Provision of late night refreshment (if ticking yes, fill in box I)

Supply of alcohol (if ticking yes, fill in box J)

In all cases complete boxes K, L and M

A

Plays Standard days and timings (please read guidance note 7)			Will the performance of a play take place indoors or outdoors or both – please tick (please read guidance note 3)		Indoors <input type="checkbox"/>
					Outdoors <input type="checkbox"/>
					Both <input type="checkbox"/>
Day	Start	Finish	Please give further details here (please read guidance note 4)		
Mon					
Tue					
Wed			State any seasonal variations for performing plays (please read guidance note 5)		
Thur					
Fri			Non standard timings. Where you intend to use the premises for the performance of plays at different times to those listed in the column on the left, please list (please read guidance note 6)		
Sat					
Sun					

B

Films Standard days and timings (please read guidance note 7)			Will the exhibition of films take place indoors or outdoors or both – please tick (please read guidance note 3)	Indoors	<input type="checkbox"/>
				Outdoors	<input type="checkbox"/>
				Both	<input type="checkbox"/>
Day	Start	Finish	Please give further details here (please read guidance note 4)		
Mon					
Tue			State any seasonal variations for the exhibition of films (please read guidance note 5)		
Wed					
Thur			Non standard timings. Where you intend to use the premises for the exhibition of films at different times to those listed in the column on the left, please list (please read guidance note 6)		
Fri					
Sat					
Sun					

C

Indoor sporting events Standard days and timings (please read guidance note 7)			<u>Please give further details</u> (please read guidance note 4)
Day	Start	Finish	
Mon			<u>State any seasonal variations for indoor sporting events</u> (please read guidance note 5)
Tue			
Wed			<u>Non standard timings. Where you intend to use the premises for indoor sporting events at different times to those listed in the column on the left, please list</u> (please read guidance note 6)
Thur			
Fri			
Sat			
Sun			

D

Boxing or wrestling entertainments Standard days and timings (please read guidance note 7)			<u>Will the boxing or wrestling entertainment take place indoors or outdoors or both – please tick</u> (please read guidance note 3)	Indoors <input type="checkbox"/>
				Outdoors <input type="checkbox"/>
				Both <input type="checkbox"/>
Day	Start	Finish		
Mon			<u>Please give further details here</u> (please read guidance note 4)	
Tue				
Wed			<u>State any seasonal variations for boxing or wrestling entertainment</u> (please read guidance note 5)	
Thur				
Fri			<u>Non standard timings. Where you intend to use the premises for boxing or wrestling entertainment at different times to those listed in the column on the left, please list</u> (please read guidance note 6)	
Sat				
Sun				

E

Live music Standard days and timings (please read guidance note 7)			Will the performance of live music take place indoors or outdoors or both – please tick (please read guidance note 3)	Indoors	<input checked="" type="checkbox"/>
Day	Start	Finish		Outdoors	<input checked="" type="checkbox"/>
Mon	14:00 AM	00:00	Please give further details here (please read guidance note 4) INDIVIDUAL OR SMALL GROUP ACTS SINGING TO BACKING MUSIC	Both	<input checked="" type="checkbox"/>
Tue	17:00 AM	00:00			
Wed	14:00 AM	00:00	State any seasonal variations for the performance of live music (please read guidance note 5) MORE REGULAR AT CHRISTMAS PERIOD, OTHERWISE MONTHLY / WEEKLY		
Thur	14:00 AM	00:00			
Fri	14:00 AM	00:00	Non standard timings. Where you intend to use the premises for the performance of live music at different times to those listed in the column on the left, please list (please read guidance note 6) NEW YEAR'S EVE UNTIL 3AM CHRISTMAS EVE UNTIL 3AM		
Sat	14:00 AM	00:00			
Sun	17:00 AM	00:00			

F

Recorded music Standard days and timings (please read guidance note 7)			Will the playing of recorded music take place indoors or outdoors or both – please tick (please read guidance note 3)	Indoors	<input checked="" type="checkbox"/>
Day	Start	Finish		Outdoors	<input type="checkbox"/>
Mon	09:00	00:00	Please give further details here (please read guidance note 4)	Both	<input type="checkbox"/>
Tue	09:00	00:00			
Wed	09:00	00:00	State any seasonal variations for the playing of recorded music (please read guidance note 5) XMAS + NEW YEARS EVE @ 3AM		
Thur	09:00	00:00			
Fri	09:00	00:30	Non standard timings. Where you intend to use the premises for the playing of recorded music at different times to those listed in the column on the left, please list (please read guidance note 6) AS ABOVE		
Sat	09:00	00:30			
Sun	09:00	00:00			

G

Performances of dance Standard days and timings (please read guidance note 7)			Will the performance of dance take place indoors or outdoors or both – please tick (please read guidance note 3)	Indoors	<input type="checkbox"/>
Day	Start	Finish		Outdoors	<input type="checkbox"/>
Mon			Please give further details here (please read guidance note 4)	Both	<input type="checkbox"/>
Tue					
Wed			State any seasonal variations for the performance of dance (please read guidance note 5)		
Thur					
Fri			Non standard timings. Where you intend to use the premises for the performance of dance at different times to those listed in the column on the left, please list (please read guidance note 6)		
Sat					
Sun					

H

Anything of a similar description to that falling within (e), (f) or (g) Standard days and timings (please read guidance note 7)			Please give a description of the type of entertainment you will be providing		
Day	Start	Finish	<u>Will this entertainment take place indoors or outdoors or both – please tick</u> (please read guidance note 3)	Indoors	<input type="checkbox"/>
Mon				Outdoors	<input type="checkbox"/>
				Both	<input type="checkbox"/>
Tue			<u>Please give further details here</u> (please read guidance note 4)		
Wed					
Thur			<u>State any seasonal variations for entertainment of a similar description to that falling within (e), (f) or (g)</u> (please read guidance note 5)		
Fri					
Sat			<u>Non standard timings. Where you intend to use the premises for the entertainment of a similar description to that falling within (e), (f) or (g) at different times to those listed in the column on the left, please list</u> (please read guidance note 6)		
Sun					

I

Late night refreshment Standard days and timings (please read guidance note 7)			Will the provision of late night refreshment take place indoors or outdoors or both – please tick (please read guidance note 3)	Indoors	<input type="checkbox"/>
				Outdoors	<input type="checkbox"/>
Day	Start	Finish		Both	<input checked="" type="checkbox"/>
Mon	23:00	00:00	Please give further details here (please read guidance note 4)		
Tue	23:00	00:00			
Wed	23:00	00:00	State any seasonal variations for the provision of late night refreshment (please read guidance note 5) NEW YEAR'S EVE + XMAS EVE UNTIL 3AM		
Thur	23:00	00:00			
Fri	23:00	01:00	Non standard timings. Where you intend to use the premises for the provision of late night refreshment at different times, to those listed in the column on the left, please list (please read guidance note 6) AS ABOVE		
Sat	23:00	01:00			
Sun	23:00	00:00			

START TIMES UPDATED BY IM - WCC LICENSING WITH PERMISSION FROM APPLICANT - 15/01/2020.

J

Supply of alcohol Standard days and timings (please read guidance note 7)			Will the supply of alcohol be for consumption – please tick (please read guidance note 8)	On the premises	<input type="checkbox"/>
				Off the premises	<input type="checkbox"/>
				Both	<input checked="" type="checkbox"/>
Day	Start	Finish	State any seasonal variations for the supply of alcohol (please read guidance note 5)		
Mon	09:00	00:00	EX MAS EVE + NEW YEARS EVE 3 AM		
Tue	09:00	00:00			
Wed	09:00	00:00			
Thur	09:00	00:00	Non standard timings. Where you intend to use the premises for the supply of alcohol at different times to those listed in the column on the left, please list (please read guidance note 6)		
Fri	09:00	01:00	AS ABOVE		
Sat	09:00	01:00			
Sun	09:00	00:00			

State the name and details of the individual whom you wish to specify on the licence as designated premises supervisor (Please see declaration about the entitlement to work in the checklist at the end of the form):

Name	FASU MIAN
Date of birth	
Address	
Postcode	
Personal licence number (if known)	MPE 0190.
Issuing licensing authority (if known)	HAVANT BOROUGH COUNCIL

K

Please highlight any adult entertainment or services, activities, other entertainment or matters ancillary to the use of the premises that may give rise to concern in respect of children (please read guidance note 9).

L

Hours premises are open to the public Standard days and timings (please read guidance note 7)			State any seasonal variations (please read guidance note 5)
Day	Start	Finish	
Mon	09:00	00:00	Non standard timings. Where you intend the premises to be open to the public at different times from those listed in the column on the left, please list (please read guidance note 6)
Tue	09:00	00:00	
Wed	09:00	00:00	
Thur	09:00	00:00	
Fri	09:00	01:00	
Sat	09:00	01:00	
Sun	09:00	00:00	

M

Describe the steps you intend to take to promote the four licensing objectives:

a) General – all four licensing objectives (b, c, d and e) (please read guidance note 10)

STRONG MANAGEMENT CONTROLS AND EFFECTIVE TRAINING OF ALL STAFF. INCLUDING ATTENTION TO THE SELLING OF ALCOHOL TO UNDERAGE PEOPLE, NO TOLERANCE OF DRUNK + DISORDERLY, NO TOLERANCE OF DRUGS USE, NO TOLERANCE OF VIOLENCE / ANTI SOCIAL BEHAVIOUR. DPS WILL ENFORCE AGREEMENTS FOR ALL STAFF TO SIGN. CHALLENGE 25 POSTERS CLEARLY SITUATED.

b) The prevention of crime and disorder

CCTV INTERNAL (ALL AREAS) AND FRONT + REAR EXTERNAL. ACCESS FOR AUTHORITIES TO DOWNLOAD CCTV AT ANY TIME. MONITOR ENTRANCE + EXITS WITH SIGNAGE. CLEAR OPERATING HOURS ON DISPLAY. SMALL MEASURES INCL. 125ML WINE AND 25ML SHOTS OFFERED. NO UP-SELLING OF DOUBLE MEASURES. NO CANNED ALCOHOL DRINKS. COMPLIANCE WITH AUTHORITY VISITS.

c) Public safety

CCTV AS ABOVE. NO SALE OF ALCOHOL TO DRUNK / DISORDERLY, INTOXICATED, WELL TRAINED STAFF TO ENVIRONMENTAL HEALTH STANDARDS. ALL PARTS OF PREMISES TO BE KEPT IN GOOD ORDER AND WELL MAINTAINED. CCTV HARD DRIVE PLUS REAL TIME RECORDING. STAFF TRAINING ON CCTV. SUPERVISED TOILET AREAS - FIRST AID BOX AND TRAINING IN PLACE

d) The prevention of public nuisance

CCTV AS ABOVE. CLEAR OPERATING HOURS. SIGNAGE REQUESTING QUIET EXITS AND RESPECT FOR NEIGHBOURS TO BE REINFORCED BY MANAGEMENT. DELIVERIES TO BE CARRIED OUT AT TIMES AND MANNER NOT TO CAUSE NOISE / DISTURBANCE. ENCOURAGE CIVILISED ATMOSPHERE. NO OVERCROWDING OR BUEVING. RESTAURANT BOOKINGS + WAITING EFFICIENTLY MANAGED.

e) The protection of children from harm

CCTV AS ABOVE. IDENTIFICATION OF ALL PERSONS UNDER 25 AND REFUSAL TO SERVE THOSE WITHOUT VALID ID. WELL TRAINED STAFF + COMPETENT MANAGEMENT. REFUSAL LOG KEPT AND MONITORED FOR RE-ENTRY. HEALTH + SAFETY POLICY IN PLACE FOR ALL EMPLOYEES AND ACKNOWLEDGED BEFORE SALE OF ALCOHOL.

Checklist:

Please tick to indicate agreement

- I have made or enclosed payment of the fee. PLEASE CALL STEPH ON
- I have enclosed the plan of the premises.
- I have sent copies of this application and the plan to responsible authorities and others where applicable.
- I have enclosed the consent form completed by the individual I wish to be designated premises supervisor, if applicable.
- I understand that I must now advertise my application.
- I understand that if I do not comply with the above requirements my application will be rejected.
- [Applicable to all individual applicants, including those in a partnership which is not a limited liability partnership, but not companies or limited liability partnerships] I have included documents demonstrating my entitlement to work in the United Kingdom (please read note 15).

IT IS AN OFFENCE, UNDER SECTION 158 OF THE LICENSING ACT 2003, TO MAKE A FALSE STATEMENT IN OR IN CONNECTION WITH THIS APPLICATION. THOSE WHO MAKE A FALSE STATEMENT MAY BE LIABLE ON SUMMARY CONVICTION TO A FINE OF ANY AMOUNT.

IT IS AN OFFENCE UNDER SECTION 24B OF THE IMMIGRATION ACT 1971 FOR A PERSON TO WORK WHEN THEY KNOW, OR HAVE REASONABLE CAUSE TO BELIEVE, THAT THEY ARE DISQUALIFIED FROM DOING SO BY REASON OF THEIR IMMIGRATION STATUS. THOSE WHO EMPLOY AN ADULT WITHOUT LEAVE OR WHO IS SUBJECT TO CONDITIONS AS TO EMPLOYMENT WILL BE LIABLE TO A CIVIL PENALTY UNDER SECTION 15 OF THE IMMIGRATION, ASYLUM AND NATIONALITY ACT 2006 AND PURSUANT TO SECTION 21 OF THE SAME ACT, WILL BE COMMITTING AN OFFENCE WHERE THEY DO SO IN THE KNOWLEDGE, OR WITH REASONABLE CAUSE TO BELIEVE, THAT THE EMPLOYEE IS DISQUALIFIED.

Part 4 – Signatures (please read guidance note 11)

Signature of applicant or applicant’s solicitor or other duly authorised agent (see guidance note 12). **If signing on behalf of the applicant, please state in what capacity.**

Declaration	<ul style="list-style-type: none"> • [Applicable to individual applicants only, including those in a partnership which is not a limited liability partnership] I understand I am not entitled to be issued with a licence if I do not have the entitlement to live and work in the UK (or if I am subject to a condition preventing me from doing work relating to the carrying on of a licensable activity) and that my licence will become invalid if I cease to be entitled to live and work in the UK (please read guidance note 15). • The DPS named in this application form is entitled to work in the UK (and is not subject to conditions preventing him or her from doing work relating to a licensable activity) and I have seen a copy of his or her proof of entitlement to work, if appropriate (please see note 15)
--------------------	--

Signature	
Date	1 JUL 2019.
Capacity	DIRECTOR

For joint applications, signature of 2nd applicant or 2nd applicant's solicitor or other authorised agent (please read guidance note 13). If signing on behalf of the applicant, please state in what capacity.

Signature	
Date	
Capacity	

Contact name (where not previously given) and postal address for correspondence associated with this application (please read guidance note 14)

FASU MIAN.
 CRAWFORD HOUSE (FORMERLY FLEWINGTONS)
 HAMBLEDON ROAD

Post town	PORTSMOUTH	Postcode	PO7 6NU
Telephone number (if any)			

If you would prefer us to correspond with you by e-mail, your e-mail address (optional)

Notes for Guidance

- Describe the premises, for example the type of premises, its general situation and layout and any other information which could be relevant to the licensing objectives. Where your application includes off-supplies of alcohol and you intend to provide a place for consumption of these off-supplies, you must include a description of where the place will be and its proximity to the premises.
- In terms of specific regulated entertainments please note that:
 - Plays: no licence is required for performances between 08:00 and 23.00 on any day, provided that the audience does not exceed 500.
 - Films: no licence is required for 'not-for-profit' film exhibition held in community premises between 08.00 and 23.00 on any day provided that the audience does not exceed 500 and the organiser (a) gets consent to the screening from a person who is responsible for the premises; and (b) ensures that each such screening abides by age classification ratings.
 - Indoor sporting events: no licence is required for performances between 08.00 and 23.00 on any day, provided that the audience does not exceed 1000.
 - Boxing or Wrestling Entertainment: no licence is required for a contest, exhibition or display of Greco-Roman wrestling, or freestyle wrestling between 08.00 and 23.00 on any day, provided that the audience does not exceed 1000. Combined fighting sports – defined as a contest, exhibition or display which combines boxing or wrestling with one or more martial arts – are licensable as a boxing or wrestling entertainment rather than an indoor sporting event.
 - Live music: no licence permission is required for:

* required information

Section 1 of 3

You can save the form at any time and resume it later. You do not need to be logged in when you resume.

System reference This is the unique reference for this application generated by the system.

Your reference You can put what you want here to help you track applications if you make lots of them. It is passed to the authority.

Are you an agent acting on behalf of the applicant?

Yes No

Put "no" if you are applying on your own behalf or on behalf of a business you own or work for.

Applicant Details

* First name

* Family name

* E-mail

Main telephone number

Include country code.

Other telephone number

Indicate here if you would prefer not to be contacted by telephone

Are you:

Applying as a business or organisation, including as a sole trader
 Applying as an individual

A sole trader is a business owned by one person without any special legal structure. Applying as an individual means you are applying so you can be employed, or for some other personal reason, such as following a hobby.

Applicant Business

Is your business registered in the UK with Companies House? Yes No

Note: completing the Applicant Business section is optional in this form.

Is your business registered outside the UK? Yes No

Business name

If your business is registered, use its registered name.

VAT number

Put "none" if you are not registered for VAT.

Legal status

Continued from previous page...

Your position in the business

Home country

The country where the headquarters of your business is located.

Business Address

If you have one, this should be your official address - that is an address required of you by law for receiving communications.

Building number or name

Street

District

City or town

County or administrative area

Postcode

Country

Section 2 of 3

CONSENT

Name Of Proposed Premises Supervisor

* First name

* Family name

Address Of Proposed Premises Supervisor

* Building number or name

* Street

District

* City or town

County or administrative area

Postcode

* Country

I hereby confirm that I give my consent to be specified as the designated premises supervisor in relation to the following application, and any premises licence to be granted or varied in respect of this application concerning the supply of alcohol at the premises

* Type of application

For instance 'Application for a premises licence' or 'Variation of a premises licence'

Is the application or variation that this consent is being submitted in connection with being supplied electronically to the authority

Yes

No

Don't know

Continued from previous page...

Reference number of
electronic application (if
known)

If the application or variation form is already
submitted, ask its applicant for the form's
'system reference' or 'your reference'.

Premises Licence Holder

* Name

FASU MIAH

Address Of Premises

* Building number or name

* Street

District

* City or town

County or administrative area

Postcode

Premises

Premise licence number

TBC

* Name of premises

KASSIA LOUNGE

I also confirm that I am applying for, intend to apply for or currently hold a personal licence, details of which I set out below

Personal licence number

MPE0190

Personal licence issuing
authority name

HAVANT BOROUGH COUNCIL

Address Of Personal Licence Issuing Authority

Building number or name

PUBLIC SERVICE PLAZA

Street

CIVIC CENTRE ROAD

District

HAVANT

City or town

HAVANT

County or administrative area

HAMPSHIRE

Postcode

PO9 2AX

Contact Details Of Personal Licence Issuing Authority

Telephone number

02922446019

Section 3 of 3

DECLARATION

Continued from previous page...

* I/we understand it is an offence, liable on conviction to a fine up to level 5 on the standard scale, under section 158 of the licensing act 2003, to make a false statement in or in connection with this application.

Ticking this box indicates you have read and understood the above declaration

This section should be completed by the applicant, unless you answered "Yes" to the question "Are you an agent acting on behalf of the applicant?"

* Full name

* Capacity

Date (dd/mm/yyyy)

Once you're finished you need to do the following:

1. Save this form to your computer by clicking file/save as...
2. Go back to <https://www.gov.uk/apply-for-a-licence/premises-licence/winchester/change-7> to upload this file and continue with your application.

Don't forget to make sure you have all your supporting documentation to hand.



strukta[®]
Specialist Builders Merchant

Name _____

Date _____

Project Reference _____

Project Title _____

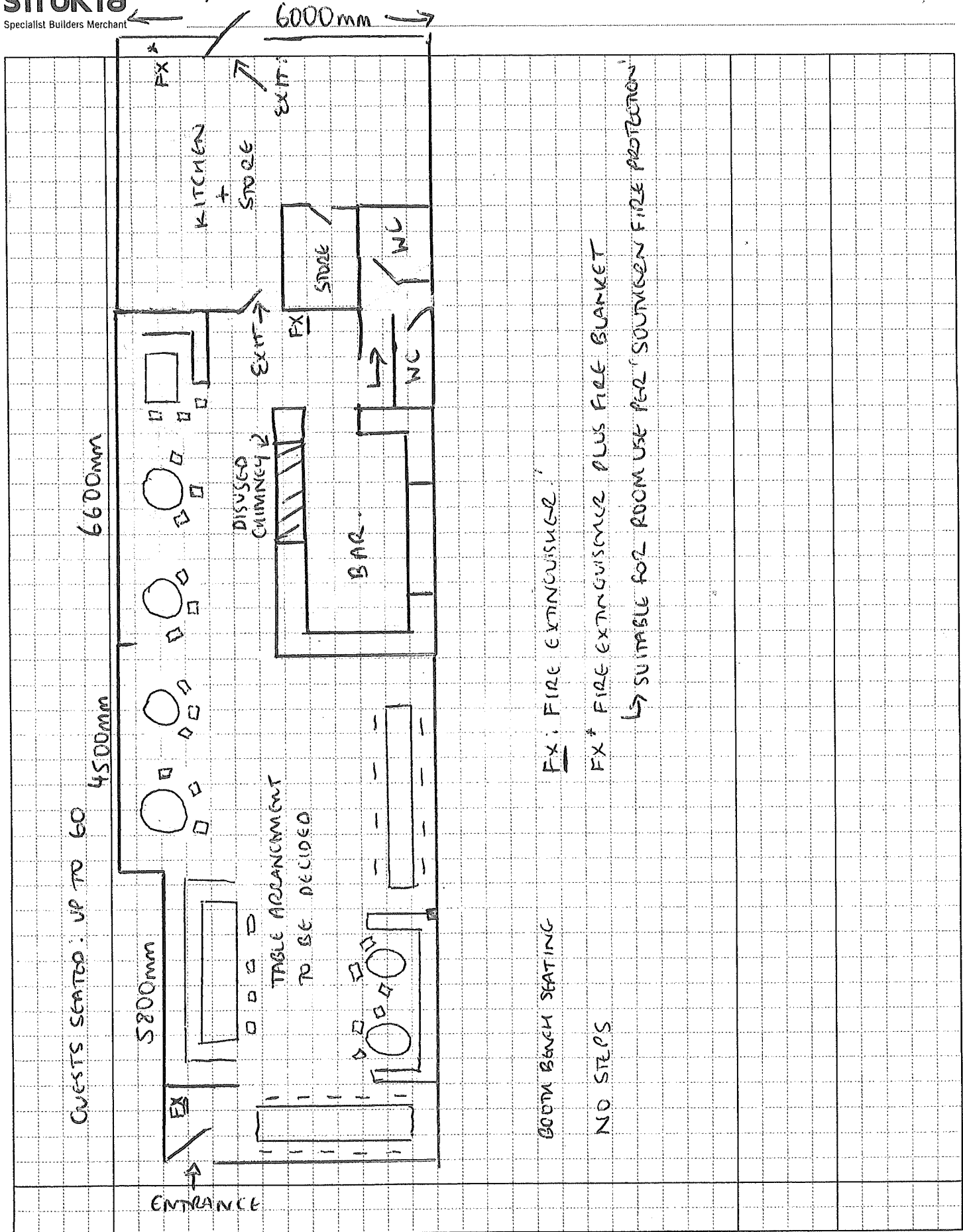

HM Land Registry Current title plan

Title number **HP641709**
Ordnance Survey map reference **SU6512SE**
Scale **1:1250 enlarged from 1:2500**
Administrative area **Hampshire : Winchester**

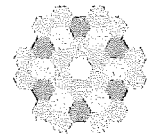

© Crown Copyright. Produced by HM Land Registry. Reproduction in whole or in part is prohibited without the prior written permission of Ordnance Survey. Licence Number 100026316



This is a copy of the title plan on 6 JAN 2020 at 14:28:29. This copy does not take account of any application made after that time even if still pending in HM Land Registry when this copy was issued.

This copy is not an 'Official Copy' of the title plan. An official copy of the title plan is admissible in evidence in a court to the same extent as the original. A person is entitled to be indemnified by the registrar if he or she suffers loss by reason of a mistake in an official copy. If you want to obtain an official copy, the HM Land Registry web site explains how to do this.

HM Land Registry endeavours to maintain high quality and scale accuracy of title plan images. The quality and accuracy of any print will depend on your printer, your computer and its print settings. This title plan shows the general position, not the exact line, of the boundaries. It may be subject to distortions in scale. Measurements scaled from this plan may not match measurements between the same points on the ground.

This title is dealt with by HM Land Registry, Weymouth Office

Appendix 2 – Representations from Responsible Authorities**Sara Hayes-Arter****Environmental Health, Winchester City Council, City Offices, Colebrook Street,
Winchester, SO23 9LJ****Received: 29/01/2020**Subject: 20/00058/LAPRMN

Kassia Lounge
Hambledon Road
Denmead
Waterlooville
Hampshire
PO7 6NU

Please accept this email as a representation regarding the above application on behalf of the Environmental Protection Team. This representation is made on the grounds that the applicant has failed to demonstrate how they will ensure compliance with the public nuisance licensing objective.

When issuing planning permission for this premises, concerns were raised regarding the potential for noise disturbance to the occupants of nearby residential dwellings. Accordingly, it was recommended that this could be effectively controlled if the opening hours of the premises were restricted. This licensing application proposes to extend the opening hours far beyond those permitted by the Local Planning Authority. Given the residential nature of the surrounding area, the proposed licensing hours are not considered suitable as there is significant potential for noise disturbance and public nuisance.

Regards

Sara

Sara Hayes-Arter

Environmental Protection Officer
Winchester City Council
Colebrook Street
Winchester
SO23 9LJ

Tel: [REDACTED] (workings days are Tuesday, Wednesday and Thursday only)

This page is intentionally left blank

Appendix 3 – Representations from Other Persons

Mr David Nicholls

Peacehaven Ashling Gardens, Denmead, PO7 6PR

Received 21 January 2020

Subject: Kassia Lounge, Crawford House, Hambledon Road, Denmead,
Waterlooville, Hampshire, PO7 6NU

Sir, I object to the application for a premises licence by Mr. Fasu Miah for the following reasons:-

1) The granting of a licence on the terms that have been applied for will lead to increased crime and disorder as a result of members of the public being able to obtain alcohol over such a long period.

The increased drunken-ness will lead to acts of criminal vandalism.

2) The long hours during which alcohol will be sold will lead to increased intoxication of customers to the Kassia Lounge causing antisocial behaviour and a public nuisance.

Live music being played up to midnight without any limitation of the sound level constitutes a public nuisance.

Mr. DJ Nicholls

Peacehaven

Ashling Gardens

Denmead PO7 6PR

Appendix 3 – Representations from Other Persons**Mr Lee Burman****29 Ashling Gardens, Denmead, PO7 6PR****Received 23 January 2020**Subject: application from Fasu Miah re Kassia lounge Denmead

Dear Sir or Madam,

I have just be made aware of an application for a drinking license for Fasu Miah for the Kassia lounge in our village of Denmead.

I live behind this building in a bungalow as part of Ashling gardens. I have to say do I not want music or alcohol served in such close proximity to a residential area. By the way the blue notice to announce this was only put up today and not visible for the 10 days which is the requirement, hints at being sneaky and not wanting any villagers to be able to reply to this application.

I am simply not prepared to put up with music every night and weekend interrupting the peace and tranquility of my garden in the village. Its a village NOT a city, where this would be more suited for. This building is far too CLOSE to our bungalows and would cause public noise and do we not need to be accosted by drunken revellers as we make our way home past this building.

Yours sincerely Mr L J Burman, 29 Ashling Gardens Denmead.

Appendix 3 – Representations from Other Persons

Mr & Mrs G & J Isaac

30 Ashling Gardens, Denmead, PO7 6PR

Received 23 January 2020

Subject: Proposed application for Cassia Lounge, Denmead.

Sir,

I wish to raise objections to the application from Fasu Miah, Cassia Lounge, Cranford House, Denmead, Waterlooville, PO7 6NU.

My main objection being with regards to:

1. Crime and Disorder. It is felt that the proposed opening hours for serving alcohol are far too long, and will cause disorder and noise in the area.
2. Prevention of public nuisance. It is again felt the inappropriate closing time for the playing of live music will cause considerable noise and disruption to the local community.

I look forward to your comments.

Yours faithfully,

Mr and Mrs G and J Isaac, 30 Ashling Gardens, Denmead, Waterlooville, PO7 6PR

Appendix 3 – Representations from Other Persons**Miles Stuart****3 Park Road, Denmead, PO7 6NE****Received 23 January 2020**Subject: Kasia Lounge, Hambledon Rd, Denmead.

Dear Sir or madam,

I wish to object to the application from Fasu Miah for Live music, Recorded Music, Late Night Refreshment and Supply of Alcohol (On + Off Premises) on the following grounds:

Live and recorded music, late night refreshment and sale of alcohol will create a **public nuisance** to local residents, may **create crime and disorder**, which could affect **public safety**. Denmead is poorly policed, and any late night disturbances will probably not be responded to in a timely manner. The application requests very late hours of opening, 0300 at Christmas and the New Year, and 0100 on Friday and Saturday evenings, with midnight being the norm during the rest of the week.

This is a very quiet neighbourhood, with many elderly people living nearby. This application will radically change the environment for local residents. The development will cause anguish and distress to local residents and will attract people into the village centre who may well be under the influence of drink (or drugs). I am very concerned that there will be noise, violence and crime if this application is approved.

Have the police been advised? Are they confident that they can deal with any problems at such a late hour in such a relatively remote location. Where will they be coming from? Bishops Waltham? If this application is not refused it will probably be very hard to get it withdrawn in the future.

Miles Stuart**3 Park Rd****Denmead****Waterlooville****PO7 6NE**

Appendix 3 – Representations from Other Persons**Colin Partlett****5 Park Road, Denmead, PO7 6NE****Received: 25/01/2020**Subject: Application from Kassia Lounge, Denmead

I wish to object to the granting of a License to Fasu Miah, Kassia Lounge, Hambledon Road, Denmead for the following reasons:

Live music until midnight would be a public nuisance as many of the nearby residents are elderly and could not tolerate the noise. Also some residents have young children who would be kept awake.

Supplying alcohol until very late would, I fear, encourage crime and disorder and a great deal of unpleasant behavior and noise. This would also affect the public safety of the residents.

I live in Park Road which is very near to the establishment and I do not see any benefit to granting this license.

Details:

Colin Partlett

5 Park Road

Denmead

PO7 6NE

Appendix 3 – Representations from Other Persons

Mr and Mrs C and M Farrow

33 Ashling Gardens, Denmead, PO7 6PR

Received: 25/01/2020

Subject: Proposed application for Kassia Lounge, Denmead

We have the following objections to the application from Fasu Miah, Kassia Lounge, Crawford House, Denmead, Waterlooville PO7 6NU

1. Crime and Disorder - We consider the opening hours for the supply of alcohol on and off the premises will cause crime and disorder in a quiet village.
2. The Prevention of Public Nuisance – We feel that the surrounding residential area will suffer noise nuisance because of the proposed late night playing of live and/or recorded music every night and especially on Christmas and New Year's Eve.

Such an establishment will disrupt the ambience of the village of Denmead.

Yours faithfully

Mr and Mrs C and M Farrow

33 Ashling Gardens

Denmead

PO7 6PR

Appendix 3 – Representations from Other Persons**Glyn Jones****26 Ashling Gardens, Denmead, PO7 6PR****Received: 25/01/2020**Subject: Application for a license for KASSIA LOUNGE – Denmead – Hampshire

Dear Sir/Madam,

I wish to represent my objection to the planning application for Kassia Lounge, Denmead, for permission to allow live and recorded music and late night sale of alcohol on the premises.

My objection is on the grounds of public nuisance as the premises are in the middle of a small village, which is surrounded by private housing which will be adversely affected by the noise of music late at night, particularly during the summer months when windows may well be left open. This problem will be further aggravated by the likelihood of disturbing the sleep patterns of school children in the area.

Denmead already possesses four public houses, and has others within a short distance outside the village, and I consider that this is ample to fulfil the needs of the village community.

Yours faithfully,

Glyn Jones

26 Ashling Gardens, Denmead. PO7 6PR

Appendix 3 – Representations from Other Persons

Anita Bolton
11 Park Road, Denmead, PO7 6NE
Received: 26/01/2020

Subject: Kassia lounge Denmead

Dear Winchester council

The proposal by Kassia lounge for live music, recorded music, late night refreshment and supply of alcohol into the early hours of the morning is in my opinion a very bad idea.

The reason for this is the area is residential and therefore increased alcohol consumption, noise and people gathering will cause more crime and disorder and effective public safety it will also be a public nuisance as the loud music will interfere especially in the summer with people trying to sleep at night.

The request for live and recorded music to be played until midnight especially during the week is preposterous as it will most definitely disturb and create a public nuisance in the local area for the local residents.

I have two small children and live in Park Road where we can hear activity around the co-op in the summer evenings we will most definitely be disturbed by loud noise & music and expect the volume of visitors to increase causing potentially more crime and disorder.

Surely there must be a compromise, perhaps loud music the supply of alcohol and late night refreshments can be offered on Christmas and New Year's Eve until midnight?

3 am seems ludicrously late to be open in a village setting.

Regards
Anita Bolton
11 Park Road, Denmead, PO7 6NE

Appendix 3 – Representations from Other Persons

**Mr and Mrs D and J Dickson
27 Ashling Gardens, Denmead, PO7 6PR
Received: 26/01/2020**

Subject: Dickson objections

Dear Sir or Madam,
We wish to raise objections to the application from Fasu Miah, Kassia Lounge, Crawford House, Denmead, Waterlooville, PO7 6NU.

Our main objection is in regards to crime and disorder. We think that the opening times for serving alcohol are much too long, with the probability of noise and disorder.

This venture is in the wrong place for live music and late night drinking. With the local public bars closed, some of those drinkers will drift into Kassia Lounge, causing excessive noise.

This area has always been a part of Denmead, so the above development will attract mostly young people from other areas.

Yours faithfully

Mr and Mrs D and J Dickson.
27 Ashling Gardens, Denmead, Waterlooville, PO7 6PR

Appendix 3 – Representations from Other Persons**John Knight****High Trees, Ashling Close, Denmead, PO7 6NQ****Received: 26/01/2020**Subject: Kassai Lounge, New Premises Licence

I welcome the opening of the Kassai Lounge in principle but wish to ensure that it does not have a detrimental impact upon the residents of neighbouring properties or the character of Denmead. Accordingly, I wish to object to the application for a New Premises Licence for the Kassai Lounge, Denmead on the grounds of the Prevention of Public Nuisance. The reasons for my objection are as follows:

1, Recorded and live music - I propose that the times be amended as follows:

Monday to Sunday - 1100 to 2300

Christmas and New Years Eve - 1100 to 0100

2. Recorded and Live music noise levels - The application makes no reference to the ambient noise levels for the music beyond the physical built boundaries of the Kassai Lounge. I consider that any licence awarded should set strict limits to ambient noise levels outside the Kassai Lounge premises to ensure that it does not cause a nuisance to residents of neighbouring properties and passers-by in this otherwise peaceful rural village

3. Late night refreshment - I propose that any refreshment served should be limited to no later than 2300 .

4. Supply of alcohol (On premises) - I propose that the times be amended as follows:

Monday to Sunday - 1100 to 2300

Christmas and New Years Eve - 1100 to 0100

5. Supply of Alcohol (Off Premises) - The application does not make it clear as to what "Off Premises" means. If "Off Premises" refers to the provision of alcohol to persons sitting at tables outside the Kassai Lounge, it becomes even more important that this should not normally happen later than 2300 since this could become a source of nuisance to residents of neighbouring properties.

However, if "Off Premises" refers to the provision of alcohol to premises other than the Kassai Lounge then this should be refused and become the subject of a special licence on a case by case basis.

I should add that I live several hundred yards from the intended premises of the Kassai Lounge and so do not anticipate being affected personally by it.

John Knight 'High Trees', Ashling Close, Denmead PO7 6NQ

Appendix 3 – Representations from Other Persons**Elisabeth and Philip Wade****1 Clarendon Close, Denmead, PO7 6NY****Received: 26/01/2020**

Subject: Fwd: Application for licence Kassia Lounge, Crawford House, Hambledon Road, Denmead, Waterlooville, Hampshire, PO7 6NU

Dear Sir/Madam

We are writing to express concern about the extent of the licensing permissions being sought by Kassia Lounge in Denmead. Our concerns relate to two issues: The prevention of (crime) and disorder The prevention of public nuisance
We live at 1 Clarendon Close in Denmead. Currently we are disturbed at night by loud music and the sounds of customers leaving The White Hart at closing time or after a special event. The disturbance is more obvious in the summer when windows are open and sound travels. We are very concerned that allowing Kassia to operate beyond the opening hours for the pub will exacerbate the noise nuisance that we are already experiencing since moving to Denmead in October 2018. In our view this constitutes a public nuisance since it impacts on our sleep and must affect other residents too.

In addition, we used to live in Drayton where Kassia has had a lounge for the last five years. Although we did not live close enough to be affected by the noise, we understand that the police were called regularly to address issues relating to public order.

The supply of alcohol off premises until 12.00 every night and 1.00 on Fridays and Saturdays is particularly alarming to those who seek to reduce public disorder and where there is little evidence of a police presence to address any concerns. How can this be considered appropriate in a place which seeks to retain the character of a village?

If Kassia is to be granted a licence in Denmead can the hours of licensing at least be comparable to those of the public houses so that noise and disturbance does not continue into the early hours of the morning as appears to be suggested in the application?

Yours faithfully

Elisabeth and Philip Wade

Our full address is 1 Clarendon Close, Denmead, PO7 6NY. Please let us know if you require any further information.

Appendix 3 – Representations from Other Persons**Peter Salisbury****11a Ashling Park Road, Denmead, PO7 6EH****Received: 29/01/2020**Subject: Application for Licence by Kassia Lounge, Denmead**Reference: APPLICATION FOR LICENCE****Kassia Lounge, Crawford House, Hambledon Road, Denmead, Hampshire, PO7 6NU**

Dear Winchester,

Whilst I do not object in principle to these premises being granted Music and Alcohol licences, the times being proposed are excessively late. Living in close proximity to these premises means that my wife and I will be required to tolerate whatever noise and possible rowdiness is generated by these activities. Times of 23:00 (Sunday to Thursday) and 00:00 (Friday to Saturday) or earlier would be more acceptable upper limits. Christmas Eve and New Years Eve should also be limited to 02:00. As you are probably aware, interrupted and/or poor quality sleep due to noise is harmful for both children and adults alike.

The application does not make clear whether music and the drinking of alcohol will take place outside the building (e.g. in the garden of the premises or in the car park area at the front of the building). This must not be permitted as it will inevitably constitute a public nuisance especially for domestic properties adjoining these gardens.

I also strongly suggest that with recent break ins to both the Co-op and the Bakery in Denmead as well as thefts from nearby properties and the continued lack of any significant Police presence in Denmead, it would be prudent for Winchester to take this opportunity to monitor the shop frontages including the Kassia Lounge with CCTV cameras to ensure that Denmead remains a peaceful and desirable Hampshire village. This would be a welcome contribution to the prevention of crime and disorder.

Regards

Peter Salisbury

Retired Management Consultant and Project Manager

11a Ashling Park Road, Denmead, Hampshire, PO7 6EH

Appendix 3 – Representations from Other Persons**Mrs Margaret Dickson****Flat 1, Oldfield House, Hambledon Road, Denmead, PO7 6NN****Received: 30/01/2020**Subject: APPLICATION FOR LICENCE - Kassia Lounge, Denmead, PO7 6NU

Dear Sirs,

I wish to register an OBJECTION to the above Application for Licence.

I am writing on behalf of my mother, Mrs Margaret Dickson, resident of Flat 1, Oldfield House, Hambledon Road, Denmead, Hampshire PO7 6NN. This development is a development of 3 flats for over 55's. All the current residents are over 70, My mother is 89 and will be 90 in May 2020.

The prevention of crime and disorder - We feel the additional traffic and people will make Denmead Village centre a target for potential criminal activities. None of the shops are open late and the Coop has already been targeted and had the ATM machine stolen. There are a number of Commercial properties which could be potential targets along with a Church and Church Hall. The development my mother lives in is one of the nearest residential properties and as she is on the ground floor this makes her a potential target. She is 89/90 years old and should this go ahead she will feel unsafe in her home.

Public Safety - We feel the additional traffic and people will cause additional litter and rubbish. There are already issues with Rats from the Coop which is adjacent to my mother's property because of the rubbish left in the Car Park. Although traps are put down it is an ongoing issue and we feel this would only increase if Kassia are providing food for customers.

The prevention of public nuisance - The additional traffic and late timings of the Licence will mean considerable added noise and disturbance as people are coming to and leaving the premises. My mothers bedroom is on the ground floor at the front of the property and this will cause a lot of disturbance and cause her much distress and upset if there are loud parties and groups. Although there is plenty of parking outside of the Crawford House property there is also a concern people will use the parking directly outside and also adjacent to Oldfield House, this will cause annoyance and distress and may make it difficult should an Emergency vehicle access be required.

I trust you will acknowledge this OBJECTION and advise what action will be taken.

Thank you for your considerations of this matter

Mrs Alexandra Watler
(daughter of Mrs Margaret Dickson)

Appendix 3 – Representations from Other Persons**David Berry****Lavinia House, Hambledon Road, Denmead, PO7 6NU****Received: 31/01/2020**

Subject: Application for licence - Kasia Lounge, Crawford House, Hambledon Road, Denmead PO7 6NU

Hello

Further to our conversation yesterday. I wish to formally object to the application for the above licence for Kasia Lounge. I am the owner of Lavinia House (next door) and Landlord to the two residential units on the first floor and the licensed premises on the ground floor (under Prem 659) which is currently let to 'Cheers'.

My objection is to the lateness of the alcohol and music licence proposals, and I would like suggest that the licence attached to my business premises (prem 659) be used as a precedence.

The reasoning behind this is because myself, the business owners and residential tenants, spent a long time consulting over our own licence. This led to a well reasoned compromise of a cut-off to the licence at 10pm.

Since the proximity of Kasia Lounge to the residential tenants would cause the same issues, I think it is reasonable to ask for the same cut-off to be applied. This will also put the adjacent business on the same footing with respect to the selling of alcohol. I have consulted with my tenants on this current application and this represents our collective view. If you need any further information, please feel free to contact me by return or tel [REDACTED].

Kind regards

Dave Berry

Appendix 3 – Representations from Other Persons**Paula Langford-Smith****Hazelwood, Forest Road, Denmead, PO7 6UE****Received: 04/02/2020**Subject: Kassia Lounge, Crawford House, Hambledon Road, Denmead. PO7 6NU

Licensing Objective: The prevention of Public Nuisance

Whilst I believe the restaurant will be a welcome addition to the facilities in the Village, I have concerns regarding the hours requested in the Licensing Application. The business will be operating in a residential area with homes immediately adjacent. There are no businesses in the vicinity that open that late, the Co-op shuts at 10pm.

The planning permission that was granted by Winchester Officers provides:

1. The use hereby permitted shall only open to customers within the following times 0900-10.30 Sunday to Thursday and 0900-2300 on Friday and Saturday.

Reason: To protect the amenities of the occupiers of nearby properties.

2. No deliveries shall taken at or dispatched from the site except between the hours of 0800 and 2000 unless otherwise agreed in writing by the Local Planning Authority.

Reason: To protect the amenities of the occupiers of nearby properties.

It would therefore seem reasonable that the License should match the opening times agreed by the Planning Permission to avoid the requirement of enforcement action.

Thank you.

Paula Langford-Smith

Hazelwood, Forest Road, Denmead. PO7 6UE

Appendix 3 – Representations from Other Persons**Ian and Pauline Cameron****5 Knowle Avenue, Knowle Village, Fareham, PO17 5LG****Received: 01/02/2020**Subject: Application for a licence, The Kasia Lounge, Denmead

We are in receipt of your Notice for an application for changes to the Licence of the Kasia Lounge. We note that this for extended hours and is asking for permission for

1. Live Music 'till 3a.m.
2. Recorded Music 'till 3a.m.
3. Food Service 'till 12pm Sunday to Thursday. 1a.m Friday and Saturday also Christmas Eve and New Years Eve.
4. Service of Alcohol, including Off licence Trade, for the same time as above.

My Wife and I own the Property right next door, No2 Lavinia Mews PO7 6NU which we let out on a long term Let.

We just cannot believe that granting of these extended trading hours, in the heart of what is a quiet neighbourhood in the evenings, are not going to have a disastrous effect on the quiet enjoyment of the people living next door to the Kasia, and possibly in the square as a whole.

We ask in the strongest possible terms that a licence to trade other than normal hours is not allowed. If there is to be a hearing that includes personal representation we would be happy to attend and look forward to receiving your notice on this point if applicable.

Yours sincerely

Ian Cameron

Pauline Cameron

Appendix 3 – Representations from Other Persons

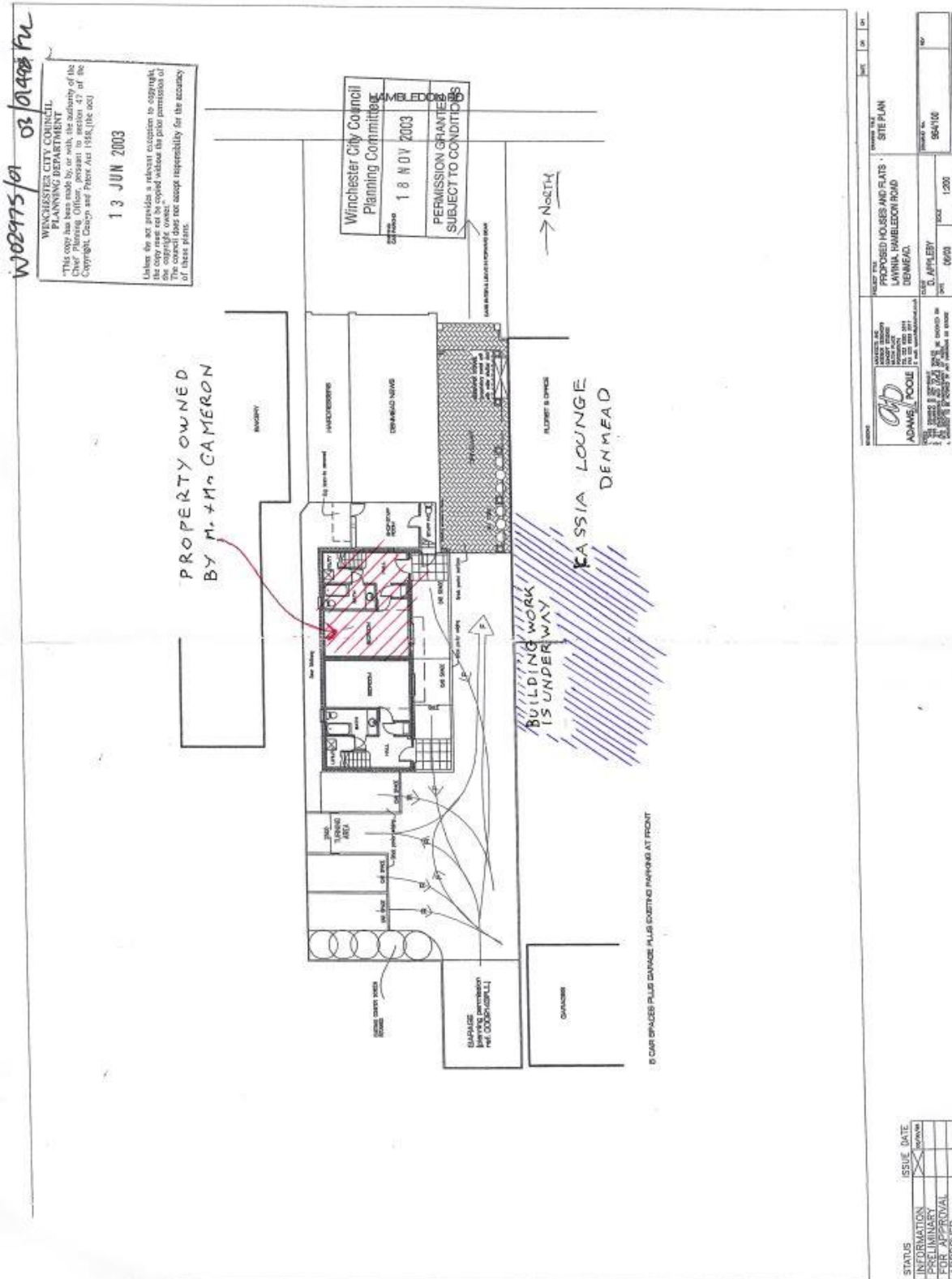

Appendix 3 – Representations from Other Persons

Alan A. J. Buswell
12 Park Road, Denmead, PO7 6NE
Received: 04/02/2020

Alan A. J. Buswell

12 Park Road
 Denmead
 Hants
 PO7 6NE

Licencing Section,
 Winchester City Council,
 City Offices,
 Colebrook Street
 Winchester, SO23 9LJ



271/2020

Licencing Application; Reference unknown.

Sir,

I understand that you have received an application from Fasu Miah, Kassia Lounge, Crawford House, Hambledon Road, Denmead, Waterlooville PO7 6NU for a New Premises Licence for Kassia Lounge, Crawford House Hambledon Road, PO7 6NU.

The purpose of this application is to provide licenceable activities for 1) Live Music, 2) Recorded Music, 3) Late Night Refreshments, 4) Supply of Alcohol on & off the Premises.

The location of this premiss is in the centre of the quiet Denmead Village amongst shops with a closing time of not later than 10pm and is also in a semi residential area of Crawford House. It fronts on private land, being space for cars and assemblies, being a possible area for public nuisance.

Nearby, closing time curtailments are in place for the Church Hall of All Saints Church and the Public House of The White Heart, both of which are within earshot of my dwelling. The Kassia Lounge, Crawford House is a similar distance away. Also there is a Fish & Chip outlet, coupled with the White Heart can give off obnoxious odours. The above premises might do the same.

I therefore strongly object to the closing times shown on the application on the grounds of unsocial late hours; neighbour disturbance and public nuisance. The time of Midnight and later is not compatible to the life of Denmeadians. An urban area might be more suitable to conduct the trade.

Yours sincerely,

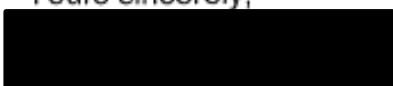

Appendix 3 – Representations from Other Persons**Ronald Burman****29 Ashling Gardens, Denmead, PO7 6PR****Received: 04/02/2020**Subject: Kassia lounge Denmead

The premises requesting the licence is located in the centre of Denmead village and surrounded by housing to all sides, late night music is bound to effect the residents in terms of noise of which may well increase during the summer months. In addition with late night drinking available this will attract more people from outside the area which would lead to more late night traffic arriving causing yet more unwanted noise and disturbances for the local residents.

My property backs onto the shops and I don't really want to hear additional noises and music late into the night coming from an additional licenced premises, I don't see any benefits for myself or residents in this area only concerns over public nuisances and possible increases in crime and disorder incidents this may lead to.

Please take these concerns into consideration when making final decision on this licence application.

Yours sincerely,

R .Burman

29 Ashling Gardens, Denmead PO7 6PR

Appendix 3 – Representations from Other Persons**Lydia Merriman (Deputy Clerk to Denmead Parish Council)****Denmead Parish Council, The Old School, School Lane, Denmead, PO7 6LU****Received: 06/02/2020**

Good Afternoon

Denmead Parish Council has resolved that the following representation should be sent to you in respect of the opening hours requested on the licensing application for Kassia Lounge, Crawford House, Hambledon Road, Denmead. PO7 6NU.

Any permission granted for the proposed hours would have a detrimental impact on Denmead's local residents, particularly in relation to the licensing objectives of the prevention of crime and disorder and the prevention of public nuisance, due to the fact that the business will be operating in a residential area with homes immediately adjacent.

The Parish Council wish to state that the License Application appears to be completely at odds with the Planning Permission already granted, and that if the times requested on the license application were to be approved, it would be considered a breach of Condition 1, as stated in the Planning Application. In this instance, Winchester City Council's Enforcement Team would be required to become involved in the matter.

Kind regards

Lydia Merriman

LYDIA MERRIMAN
Deputy Clerk to the Parish Council
Denmead Parish Council
The Old School
School Lane
Denmead
PO7 6LU

Appendix 3 – Representations from Other Persons

Ruby Stanlet-George

5A Park Road, Denmead, PO7 6NE

Received: 11/02/2020

Subject: Kasia Lounge, Denmead

I wish to object to a license being granted to Fasu Miah, Kasia Lounge, Crawford House, Denmead for the following reasons:

The late opening hours would cause a public nuisance. I live opposite the building. Late night drinking would cause a public nuisance and public safety would suffer because of this.

My details are:

Ruby Stanlet-George

5A Park Road

Denmead

PO7 6NE

Appendix 3 – Representations from Other Persons

Ian Williams

Stonyfell, Kidmore Lane, Denmead, PO7 6JZ

Received: 11/02/2020

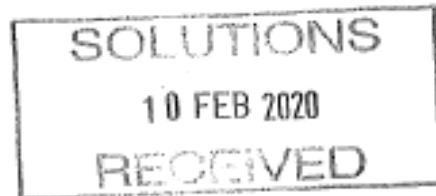

'Stonyfell'
Kidmore Lane
Denmead
Waterlooville
PO7 6JZ



06-Feb-2020

Winchester City Council
Colebrook Street
Winchester.

Dear Sir/Madam,

We have received notice of the application for licence the change of use at Crawford House, Hambledon Road, Denmead. PO7 6NU. I would like to register my strong objection to the excessive opening hours in this application.

There was a previous occasion when a late night supper / disco music licence was granted to an expanded public house in Denmead which caused chaotic nuisance in the village involving many requests for police control.

When the Co-op convenience shop and existing public houses close at 10 / 11 pm the village goes to sleep. The earlier and later hours requested in this application will be a nuisance to the occupants in adjacent dwellings with vehicle and music noise out of character the peaceful village atmosphere.

Yours sincerely

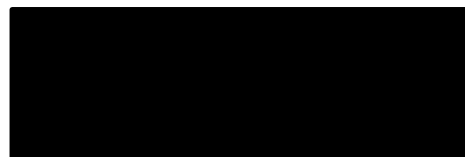

Ian Williams.

Cc. Denmead Parish Council.

Appendix 3 – Representations from Other Persons

Kevin Andreoli

6 The Meadow, Denmead, PO7 6YJ

Received: 11/02/2020

Subject: Kassia Lounge, Crawford House, Hambledon Road, Denmead. PO7 6NU

Licensing Representation: Public Safety

The Licensing Application calls for long hours of either recorded or live music. Loud music, particularly common in the live situation, can be damaging to the health and wellbeing of neighbours and the staff employed by the venue. There are neighbours in flats above the venue, across the road, and above the neighbouring shops.

Licensing Representation: The prevention of Public Nuisance

The hours requested in the Licensing Application are excessive.

The business will be operating in a residential area with homes across the road, above the venue, and above the neighbouring shops. The only businesses in the vicinity that open late are the local pubs, all of which close at 11pm.

Kevin Andreoli

6, The Meadow

Denmead

PO7 6YJ

Appendix 3 – Representations from Other Persons

Edna Goodman (On Behalf of Denmead Village Association)

28 Park Road, Denmead, PO7 6NE

Received: 11/02/2020

Subject: Kassia Lounge, Denmead, New Premises Licence

Denmead Village Association (DVA) was founded in 1973 and has 103 members. One of the Executive Committee has been landlord of 'The Forest of Bere' Public House in Denmead.

1. My association has concerns about the application by Kassia Lounge for a New Premises Licence for Recorded and Live Music and Alcohol.

The proposed opening hours seem to be a breach of agreement of WCC Case No 17/02031/FUL issued on Friday 12th July 2018.

Closing hours were to be:-

Monday – Thursday 10.30pm

Friday – Saturday 11.00pm

Sunday morning only.

2. Recorded and Live Music Licence

We are concerned about noise levels. Conditions should be laid down to keep music within the confines of the building.

Loud music all day could be very annoying to local businesses, residents and passers-by.

The Co-op closes at 10.00pm. Denmead has a quiet village centre. The suggested hours could be detrimental to local residents some of whom live above the businesses, a number of which have children.

We propose these amended times:-

Monday to Saturday 11.00am – 11.00pm

Sunday 11.00am – 10.00pm

Christmas Eve 11.00am – 10.30pm

New Year's Eve 11.00am – 1.00am.

3. Late night refreshment

Should be served NO later than 10.00pm.

4. Supply of alcohol

We are not clear what 'off premises' means. If alcohol is served outside at the front and back of the premises it could cause a Public Nuisance.

We propose these amended times:-

Monday to Saturday 11.00am – 10.30pm

Sunday 11.00am – 10.00pm

Christmas Eve 11.00am – 10.00pm

New Year's Eve 11.00am – 1.00am.

Although the Licensing Authority has laid down the conditions to be agreed by the Applicant and the Police, there have been reports of fighting outside a similar business in Clanfield causing a Public Nuisance.

Appendix 3 – Representations from Other Persons

If these hours are allowed it could become a “watering hole” for those who seek alcohol when other premises are closed.

Late opening will involve movement of vehicles, slamming car doors and raised voices as people say, ‘farewell’.

Also staff will leave later, so the disturbance could go on into the early hours disturbing the rest of local people.

One of the DVA’s main objectives is to maintain its Village Identity.

The proposal is more for a town than a village.

We also care for the contentment of the people.

This new business should *not upset* the ambience of Denmead.

Yours, with respect.

Edna Goodman

Acting Chair

Denmead Village Association

cc Denmead Parish Council

Appendix 3 – Representations from Other Persons

Anne Huckin

Greystones, Kidmore Lane, Denmead, PO7 6JZ

Received: 11/02/2020

Anne Huckin
Greystones
Kidmore Lane
Denmead PO7 6JZ

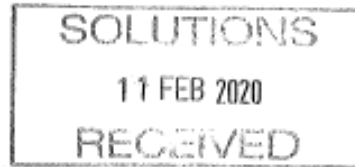

LICENSING
12 FEB 2020
W. C. C.

Winchester City Council
Colebrook St.
Winchester
SO23 9LJ

10 February 2020

Objection to Kassia Lounge application for alcohol/music license.

I live next to the church in Denmead. There are no buildings between my home and Kassia Lounge in the village centre. At the current time, the last business to close in the centre is The Co-op at 10pm. Kassia Lounge has applied to play music and serve alcohol until midnight during the week and 1:00 am at weekends. I will certainly be disturbed at these hours by music and by the coming and going of cars and customers. I believe that such early morning drinkers are particularly loud and uninhibited.

When bars have live music, they always turn the volume up. This will certainly disturb the peace and quiet of the village. No pub in the area stays open this long and I am concerned that the late night opening hours will attract people to come to the village to drink some more and will promote drunkenness in Denmead. This will make the village less safe.

The centre of the village is home to many retired and elderly people. The Kassia Lounge is a totally inappropriate and unwelcome addition to the village.

Your sincerely

Anne Huckin

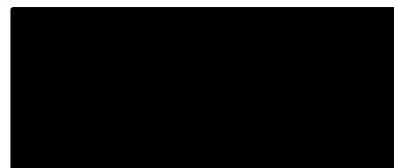

Appendix 3 – Representations from Other Persons

Mrs A Vine

10 Park Road, Denmead, PO7 6NE

Received: 11/02/2020

LICENSING

12 FEB 2020

W. C. C.

Mrs. A. Vine, 10, Park Road,
Denmead,
Hants,
PO7 6NE.
8.2.2020

Licensing Section,
Winchester City Council,
City Offices,
Colebrook Street,
Winchester SO23 9LJ.



Dear Sir or Madam,
In reference to the application for a premises
licence for Fasa Miah, Kasia Lounge, Crawford House,
Denmead, PO7 6NU.

I feel that a large town or City would be more
suitable for this kind of premises, live and
recorded music, and alcohol on and off the premises
so late at night!, surely it's not acceptable in a
village like Denmead. I live in Park Road which
runs behind some of the shopping area, and
will be in earshot from the noise of the music,
possible rowdiness from alcohol consumption and
traffie. We already have two public houses, a
fish and chip shop and a Chinese Takeaway,
and I feel, for a village that it is quite sufficient.
We want it to be as peaceful as is possible.

Yours Sincerely,

(MRS. A. VINE.)

Appendix 3 – Representations from Other Persons

Mr M R Vine

10 Park Road, Denmead, PO7 6NE

Received: 11/02/2020

Licensing section,
Winchester City Council,
City Offices,
Cotebrook Street,
Winchester. SO23 9LJ.

Mr. M.R. Vine. 10, Park Road,
Denmead,
Hants.
PO7 6NE.
8.2.2020.

Dear Sir or Madam,

It has come to my attention that you have received a premises licence application for Fasa Miah, Kassia Lounge, Cranford house, Hambledon Road, Denmead, PO7 6NU.

It seems to me to be some sort of night club, with live and recorded music, late night refreshment and alcohol, until very late. I feel it is inappropriate for a village like Denmead. I live in Park Road which runs behind the shopping area, very close to the Kassia Lounge, and in earshot of the noise from the music, rowdiness and late night traffic.

We already have two public houses, a Indian restaurant, a chinese takeaway and fish and chip shop, surely that is quite enough.

I feel that a more urban location may be more suitable for that kind of premises.

Yours Sincerely,



(MR. M.R. VINE)

Appendix 4 – Map of Representations

This map shows the location of the premises (green) and the addresses from which representations were received (red). This map does not include the addresses of Lydia Merriman or Edna Goodman as their representations were made on behalf of multiple residents of Denmead by Denmead Parish Council and the Denmead Village Association respectively. This map is not to scale.

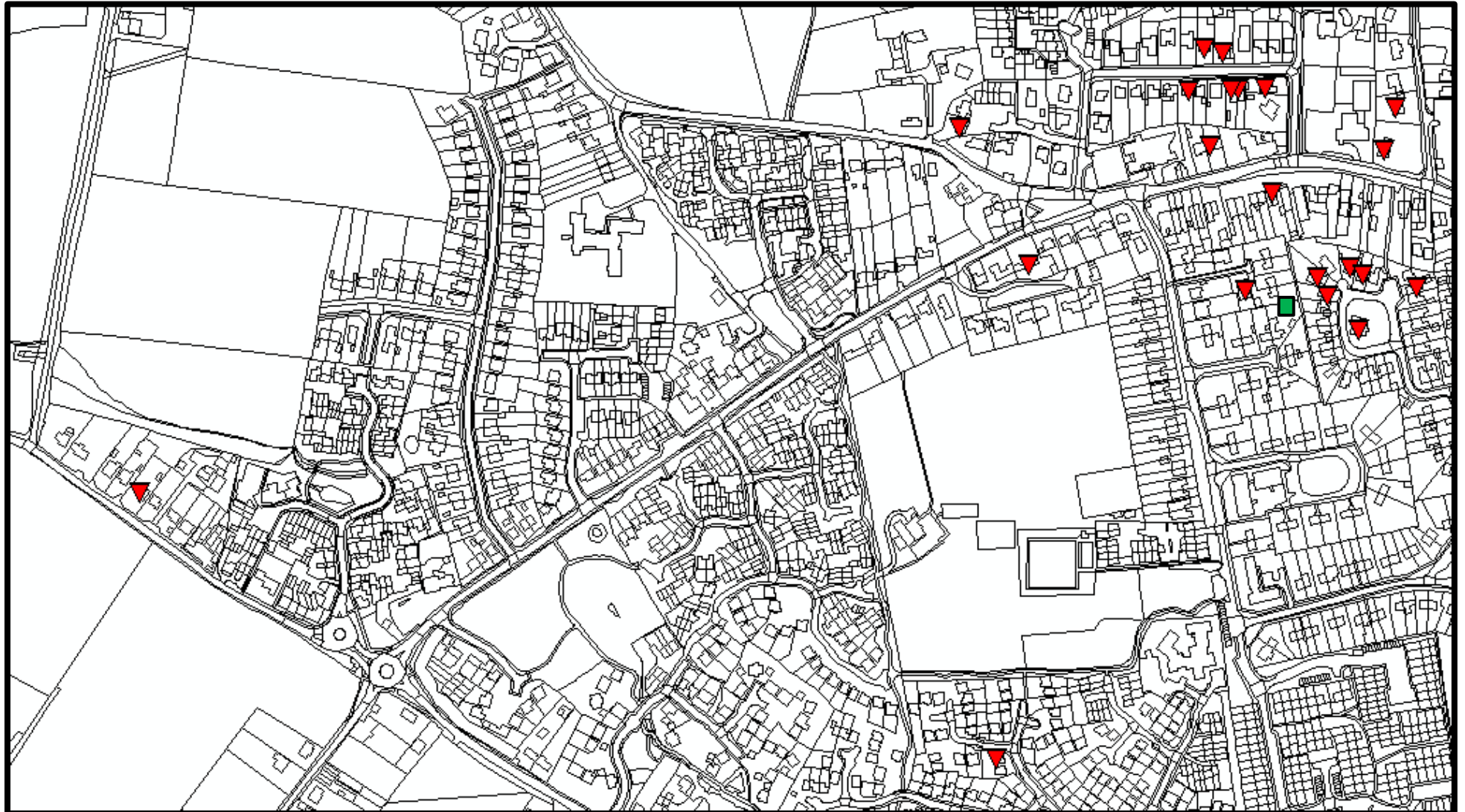

This page is intentionally left blank